

WEST END - PLAN

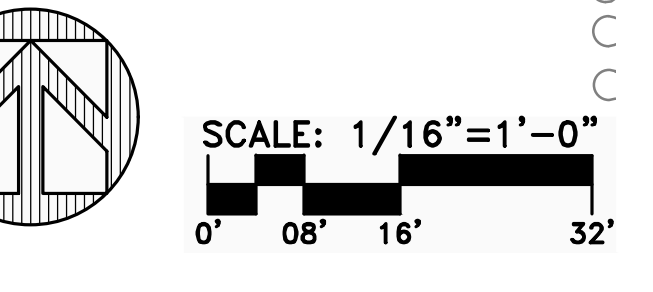

EAST END - PLAN

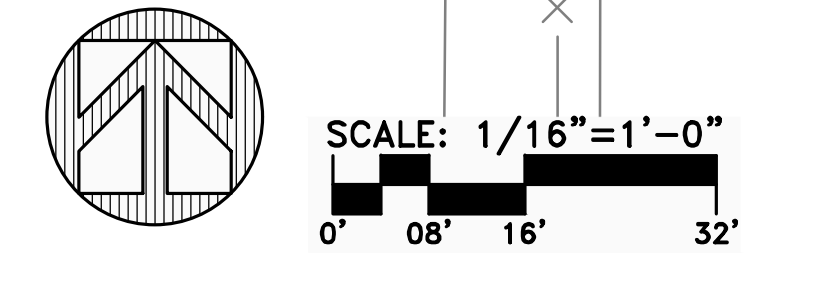

Cal Pak - Irrigation Water Requirement Calculations

City Name: Carson, California  
 Evapotranspiration Rate: 39.7 In./Yr.

**MAWA (Maximum Applied Water Allowance)**

	Eto*	Conver-sion	ET Adjustmen-t Factor	LA (Square Feet)	Addn'l ET Adjustment	SLA (Square Feet)	MAWA
PLANTED AREA	39.7 X	0.62 X	0.45 X	15,325 +	0.45 X	0 =	169,744 Gal./Yr
<b>TOTAL</b>				<b>15,325 SF</b>			<b>169,744 Gal./Yr</b>

Notes:  
 \* CIMIS (Station174; Longbeach, CA SPV)  
 ETo - Reference Evapotranspiration Rate in Inches per Year  
 ETAF - Evapotranspiration Adjustment Factor  
 SLA - Landscape Area (Square Feet)  
 Conversion Factor- to gallons per square foot (0.62)  
 Add'l Conversion Factor - ET Adjustment for Special Landscaped Area  
 MAWA - Maximum Applied Water Allowance (Gal./Yr.)

**EAWU (Estimated Applied Water Use)**

	Eto*	Conver-sion	Plant Factor	HA	IE	SLA	EAWU
Warm Season Turf (Rotor Irrigation)	39.7 x	0.62 x	0.6 x	0 /	0.75 +	0 =	0 Gal./Yr
Medium Water Use Plants (Deep Tree Wells)	39.7 x	0.62 x	0.5 x	440 /	0.85 +	0 =	6,371 Gal./Yr
Low Water Use Plants (Drip Irrigation)	39.7 x	0.62 x	0.3 x	5,602 /	0.85 +	0 =	48,666 Gal./Yr
Low Water Use Plants (Overhead Irrigation)	39.7 x	0.62 x	0.3 x	9,283 /	0.75 +	0 =	91,397 Gal./Yr
<b>TOTAL</b>				<b>15,325 SF</b>			<b>146,434 Gal./Yr</b>

Notes:  
 ETWU - Estimated total water use (in Gallons Per Year)  
 ETo - Reference Evapotranspiration Rate in Inches per Year  
 0.62 - Conversion Factor  
 PF - Plant Factor  
 HA - Hydrozone (in Square Feet)  
 IE - Irrigation Efficiency  
 SLA - Special Landscape Area

- LANDSCAPE NOTES**
1. ALL LANDSCAPE AREAS TO BE MAINTAINED WITH A PERMANENT IRRIGATION SYSTEM WHICH DELIVERS WATER TO ALL LANDSCAPED AREAS (CMC 9162.52.B.1)
  2. TREES LOCATED WITHIN 5' OF HARDSCAPE, WALLS AND BUILDING FOUNDATIONS SHALL BE PLANTED WITH ROOT CONTROL BARRIERS.
  3. ALL PLANTED AREAS TO BE MULCHED WITH DECOMPOSED GRANITE.

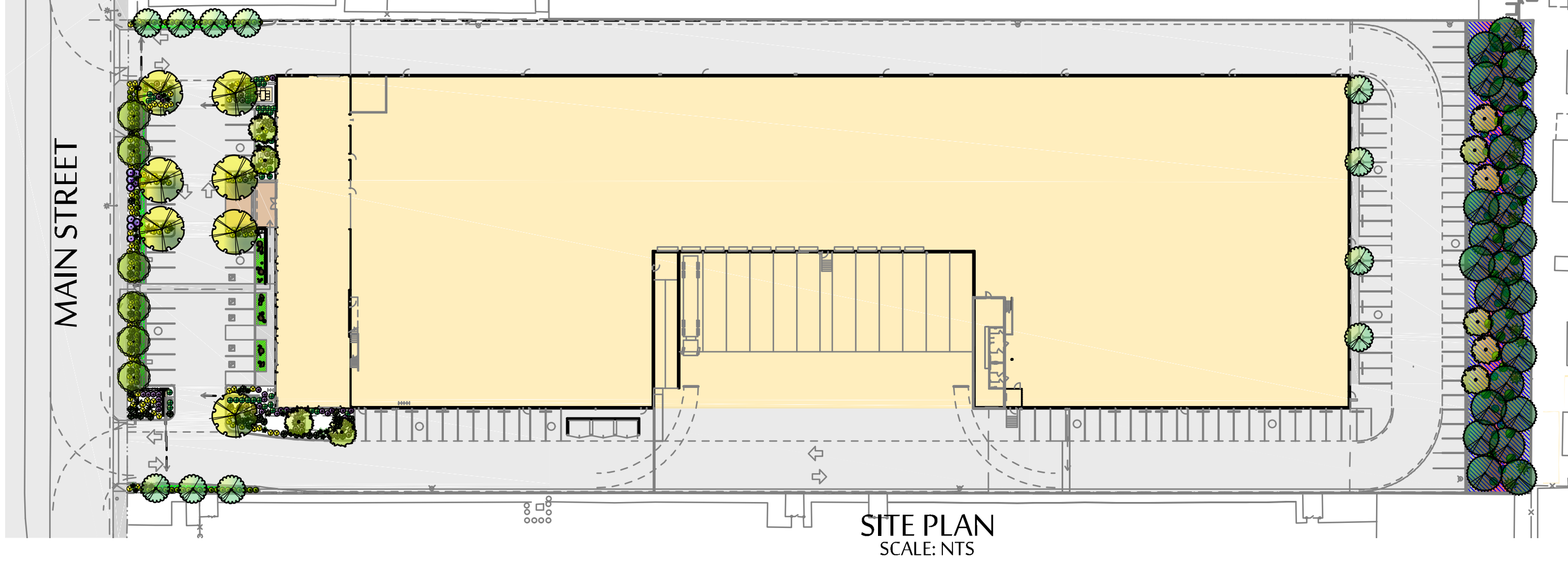

**PRELIMINARY PLANTING LEGEND**

SYMB.	INIT.	BOTANICAL NAME	COMMON NAME	SIZE	PF	COMMENTS
<b>TREES</b>						
[Symbol]	CAS CUN	CASUARINA CUNNINGHAMIANA	RIVER SHE OAK	15 GAL.	L	STANDARD
[Symbol]	BRA POP	BRACHYCHITON POPULNEUS	BOTTLE TREE	24" BOX	L	NATURAL BRANCHED
[Symbol]	GEI PAR	GEIJERA PARVIFLORA	AUSTRALIAN WILLOW	24" BOX	L	STANDARD
[Symbol]	GIN BIL	GINKGO BILOBA 'AUTUMN GOLD'	MAIDENHAIR TREE	24" BOX	M	STANDARD
[Symbol]	PAR DES	PARKINSONIA 'DESERT MUSEUM'	DESERT MUSEUM PALO VERDE	36" BOX	L	STANDARD
<b>SHRUBS</b>						
[Symbol]	AGA AME	AGAVE AMERICANA	CENTURY PLANT	5 GAL.	L	
[Symbol]	AGA PAR	AGAVE PARRYI	PARRY'S AGAVE	5 GAL.	L	
[Symbol]	CAE GIL	CAESALPINIA GILLIESII	YELLOW BIRD OF PARADISE	5 GAL.	L	
[Symbol]	HET ARB	HETEROMOLES ARBUTIFOLIA	TOYON	5 GAL.	L	
[Symbol]	LAN LS	LANTANA 'LEMON SWIRL'	LEMON SWIRL HYBRID LANTANA	5 GAL.	L	
[Symbol]	LAN MON	LANTANA MONTEVIDENSIS	PURPLE LANTANA	5 GAL.	L	
[Symbol]	LEU COM	LEUCOPHYLLUM FRUTESCENS 'COMPACTA'	COMPACT TEXAS RANGER	5 GAL.	L	
[Symbol]	LEU ZYG	LEUCOPHYLLUM ZYGOPHYLLUM	NCN	5 GAL.	L	
[Symbol]	ROS BS	ROSMARINUS OFFICINALIS 'BLUE SPIRES'	BLUE SPIRES ROSEMARY	5 GAL.	L	
[Symbol]	ROS HC	ROSMARINUS OFFICINALIS 'HUNTINGTON CARPET'	HUNTINGTON CARPET ROSEMARY	5 GAL.	L	

**PRELIMINARY PLANTING LEGEND**

SYMB.	INIT.	BOTANICAL NAME	COMMON NAME	SIZE	PF	COMMENTS
<b>SHRUBS (Cont'd)</b>						
[Symbol]	RHA MIN	RHAPHIOLEPIS UMBELLATA 'MINOR'	YEDDO HAWTHORN	5 GAL.	L	
[Symbol]	RHU OVA	RHUS OVATA	NCN	5 GAL.	L	
[Symbol]	SAL CLE	SALVIA CLEVELANDII	CLEVELAND SAGE	5 GAL.	L	
[Symbol]	SEN VIT	SENECIO VITALIS	BLUE CHALK STICKS	1 GAL.	L	PLANT 1'-6" ON CENTER
[Symbol]	SUC	VARIOUS SUCCULENTS	BLUE CHALK STICKS, ECHEVERIA, PERUVIAN APPLE CACTUS, KANGAROO PAW, EUPHORBIA	1 GAL. 5 GAL.	L	
[Symbol]	MED MIX	NATIVE MEADOW MIX	YARROW, OX-EYE DAISY, CA POPPY, SMALL FESCUE, LUPINE, NEEDLE GRASS, AND OTHERS	SEED	L	HYDRO-SEED

**PRELIMINARY PLANTING LEGEND**

SYMB.	INIT.	BOTANICAL NAME	COMMON NAME	SIZE	PF	COMMENTS
[Symbol]	RHA MIN	RHAPHIOLEPIS UMBELLATA 'MINOR'	YEDDO HAWTHORN	5 GAL.	L	
[Symbol]	RHU OVA	RHUS OVATA	NCN	5 GAL.	L	
[Symbol]	SAL CLE	SALVIA CLEVELANDII	CLEVELAND SAGE	5 GAL.	L	
[Symbol]	SEN VIT	SENECIO VITALIS	BLUE CHALK STICKS	1 GAL.	L	PLANT 1'-6" ON CENTER
[Symbol]	SUC	VARIOUS SUCCULENTS	BLUE CHALK STICKS, ECHEVERIA, PERUVIAN APPLE CACTUS, KANGAROO PAW, EUPHORBIA	1 GAL. 5 GAL.	L	
[Symbol]	MED MIX	NATIVE MEADOW MIX	YARROW, OX-EYE DAISY, CA POPPY, SMALL FESCUE, LUPINE, NEEDLE GRASS, AND OTHERS	SEED	L	HYDRO-SEED

XEBEC  
 504 EAST SLAUSON AVENUE  
 COMMERCE, CALIFORNIA

**PRELIMINARY PLANTING PLAN**

**CALIFORNIA PAK INC.**

CARSON, CALIFORNIA

**RAINVILLE-BYE LANDSCAPE ARCHITECTS**

100 W. MAIN STREET, SUITE 12, TUSTIN, CA 92780  
 TEL: (714) 838-7200 E-MAIL: gorybye@att.net

**SHEET PAO1**

PROJECT NUMBER: BYE-2016.114.00  
 PLOT DATE: 09 JUNE 2017