

LEGEND

- PROPERTY BOUNDARY
- EXISTING LOT LINE
- EXISTING BUILDING
- EXISTING STORAGE TANK
- EXISTING PRIVATE ROAD
- PROPOSED 4" PVC GAS LINE
- PROPOSED A.C. PAVING
- PROPOSED COMPRESSED NATURAL GAS (CNG) SYSTEM COMPOUND

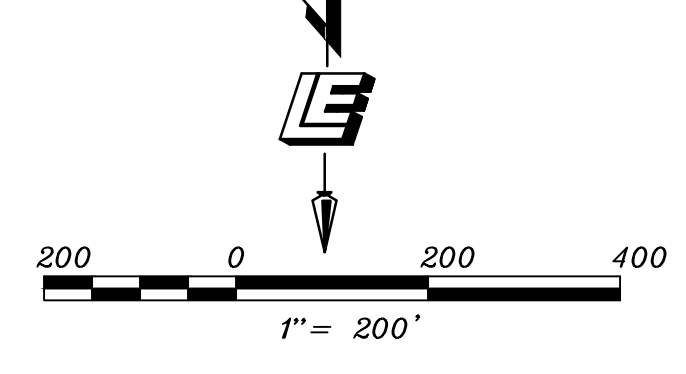

NOTE:
 SITE PLAN SHALL MEET ALL ENGINEERING AND NPDES REQUIREMENTS.

OFFSITE TRUCK ROUTE:
 A. WILMINGTON AVENUE BETWEEN DOMINGUEZ STREET AND DEL AMO BOULEVARD.
 B. DEL AMO BOULEVARD BETWEEN WILMINGTON AVENUE AND THE LONG BEACH FREEWAY.
 C. ALAMEDA STREET NORTH AND SOUTH OF DEL AMO BOULEVARD.

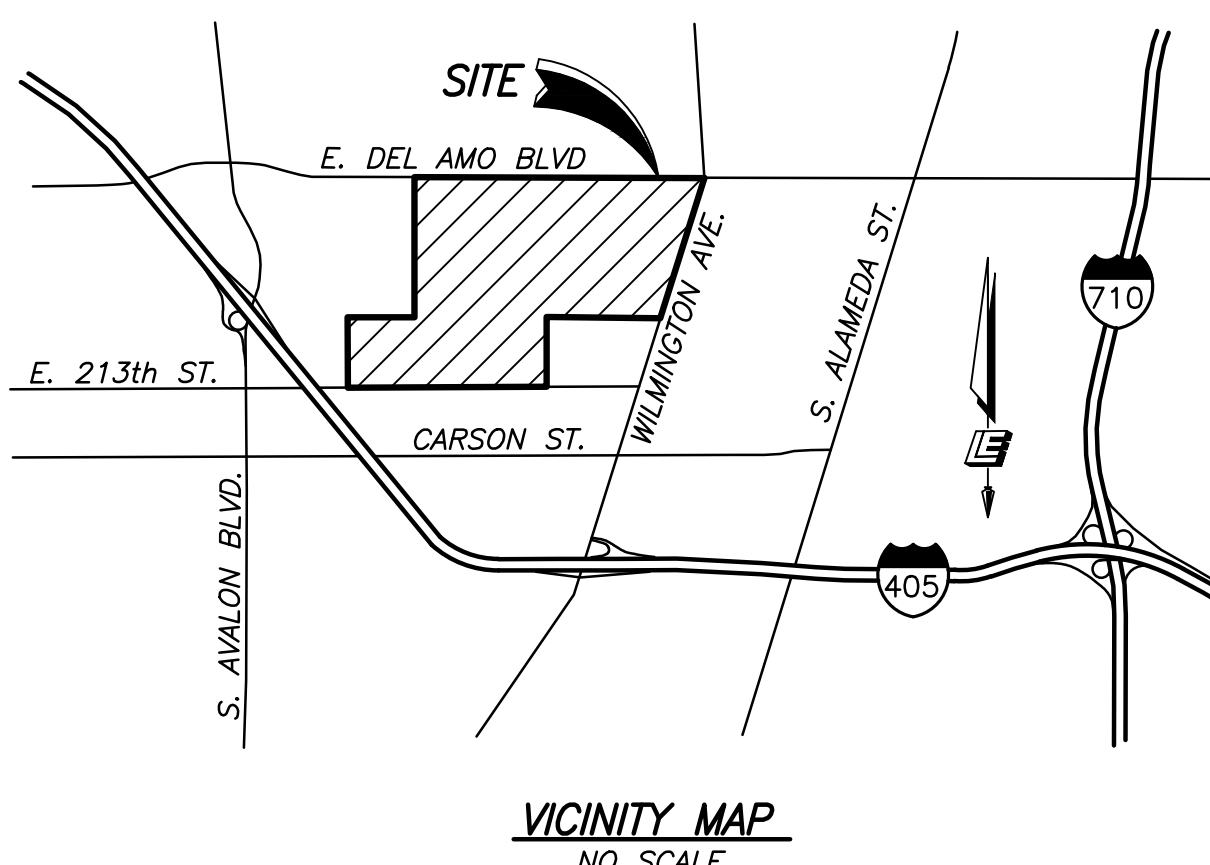

PROPERTY OWNER/APPLICANT:
 EQUILON ENTERPRISES LLC AND SHELL COMPANY OF CALIFORNIA
 20945 WILMINGTON AVENUE
 CARSON, CA 90810

EXISTING ZONING:
 MANUFACTURING - HEAVY, D-OVERLAY

TOTAL PROJECT AREA:
 436.60 ACRES

PROPERTY ADDRESS:
 20945 WILMINGTON AVENUE
 CARSON, CA 90810

PREPARED BY:
 LEPPERT ENGINEERING CORPORATION
 5190 GOVERNOR DRIVE, SUITE 205
 SAN DIEGO, CA 92122
 (619) 597-2001

2/18/2021
 JOHN D. LEPPERT DATE

LEGAL DESCRIPTION:

PARCEL 1: (APNS: 7318-018-002, 7318-018-006 AND 7327-002-021)
 PARCEL 1 OF CERTIFICATE OF COMPLIANCE FOR LOT LINE ADJUSTMENT NO. 116-99, IN THE CITY OF CARSON, COUNTY OF LOS ANGELES, STATE OF CALIFORNIA, RECORDED MAY 10, 1999 AS INSTRUMENT NO. 99-0843155 OF OFFICIAL RECORDS IN THE OFFICE OF THE COUNTY RECORDER OF SAID COUNTY.

PARCEL 2: (7327-002-008, 7327-002-013, 7327-002-014, 7327-002-015, 7327-002-016 AND 7327-002-019)
 LOTS 18, 19, 20, 21, 22, 23, 24, 25, 27, 28, 29, 38, 39, 40 AND 41 OF TRACT NO. 4054, IN THE CITY OF CARSON, COUNTY OF LOS ANGELES, STATE OF CALIFORNIA, AS PER MAP RECORDED IN BOOK 44, PAGES 39, 40 AND 41 OF MAPS, IN THE OFFICE OF THE COUNTY RECORDER OF SAID COUNTY.

PARCEL 3: (APNS: 7327-002-012 AND 7327-002-017)
 THAT PORTION OF PERRY STREET, 50.00 FEET WIDE, AS SHOWN ON THE MAP OF TRACT NO. 4054, IN THE CITY OF CARSON, COUNTY OF LOS ANGELES, STATE OF CALIFORNIA, AS PER MAP RECORDED IN BOOK 44 PAGES 39, 40 AND 41 OF MAPS, IN THE OFFICE OF THE COUNTY RECORDER OF SAID COUNTY, VACATED BY RESOLUTION OF THE BOARD OF SUPERVISORS OF SAID COUNTY, A CERTIFIED COPY OF THE ORDER THEREOF WAS RECORDED FEBRUARY 24, 1966 AS INSTRUMENT NO. 3333 IN BOOK D3217 PAGE 668, OFFICIAL RECORDS, IN THE OFFICE OF THE COUNTY RECORDER OF SAID COUNTY, WHICH EXTENDS FROM THE NORTHERLY LINE OF SAID TRACT, SOUTHERLY TO A LINE PARALLEL WITH AND 5.00 FEET NORTHERLY MEASURED AT RIGHT ANGLES, FROM THE SOUTHERLY LINE OF LOT 29 OF SAID TRACT 4054, EXCEPT THEREFROM THAT PORTION OF PERRY STREET INCLUDED WITHIN THE LINES OF THE LAND SHOWN AS PARCEL 1 OF NOTICE OF MERGER - LOT MERGER NO. 119-99, CERTIFICATE OF COMPLIANCE, RECORDED SEPTEMBER 3, 1999 AS INSTRUMENT NO. 99-1681512, OF OFFICIAL RECORDS IN THE OFFICE OF THE COUNTY RECORDER OF SAID COUNTY.

PARCEL 4: (APNS: 7326-001-003)
 LOTS 42, 43, 44 AND 45 OF TRACT NO. 4054, IN THE CITY OF CARSON, AS PER MAP RECORDED IN BOOK 44 PAGES 39, 40 AND 41 OF MAPS, IN THE OFFICE OF THE COUNTY RECORDER OF SAID COUNTY.

PARCEL 5: (APNS: 7326-001-004)
 LOTS 54, 55, 56 AND 57 OF TRACT NO. 4054, IN THE CITY OF CARSON, AS PER MAP RECORDED IN BOOK 44 PAGES 39, 40 AND 41 OF MAPS, IN THE OFFICE OF THE COUNTY RECORDER OF SAID COUNTY.

PARCEL 6: (APNs: 7318-018-007 OLD) (7318-018-008 NEW)
 A PORTION OF PARCEL 1 OF LOT LINE ADJUSTMENT NO. 287-19 CERTIFICATE OF COMPLIANCE RECORDED JULY 23, 2019 AS INSTRUMENT NO. 20190718431 OFFICIAL RECORDS.

PROJECT DESCRIPTION:
 EQUILON ENTERPRISES LLC D/B/A SHELL OIL PRODUCTS US (SHELL), IN ITS CAPACITY AS OWNER AND OPERATOR OF THE SHELL CARSON DISTRIBUTION TERMINAL PROPOSES TO IMPLEMENT THE CARSON RENEWABLE COMPRESSED NATURAL GAS (CNG) DISPENSING PROJECT (PROJECT), WHICH WOULD INSTALL A 4-INCH NATURAL GAS PIPELINE, TWO CNG DISPENSERS, AND A CNG SYSTEM COMPOUND THAT WOULD INCLUDE TWO COMPRESSORS, A DRYER, AND TWO (2) THREE-TUBE CNG STORAGE TANKS TOTALING 69,400-SGF (STANDARD CUBIC FOOT) AT 4500-PSIG (POUNDS PER SQUARE INCH GAGE). THE PROPOSED IMPROVEMENTS WOULD ENABLE THE CONVERSION OF SEVEN TRUCKS FROM DIESEL FUEL TO RENEWABLE CNG FUEL.

THE PROPOSED PROJECT WOULD BE DESIGNED IN COMPLIANCE WITH REQUIREMENTS SET FORTH IN DESIGN OVERLAY REVIEW (DOR) 764-01. THE ETHANOL TRUCK TRAFFIC TO AND FROM THE TERMINAL IS REGULATED BY THE DOR AND THE CURRENT LIMIT IS A MAXIMUM OF 210 TRUCKS/DAY WITH A MAXIMUM ANNUAL AVERAGE OF 195 TRUCKS/DAY. THE PROPOSED PROJECT WOULD NOT INCREASE THE NUMBER OF TRUCKS COMING TO THE PROJECT SITE ON A DAILY BASIS.

REVISIONS	
NO.	DATE
1	10/27/20
2	1/14/21
3	2/18/21
4	
5	
6	
7	
8	
9	
10	
DATE	1/14/21
SCALE	1"=200'
DRAWN	MO
JOB	CA1.01-31.08
SHEET	1
OF	3 SHEETS

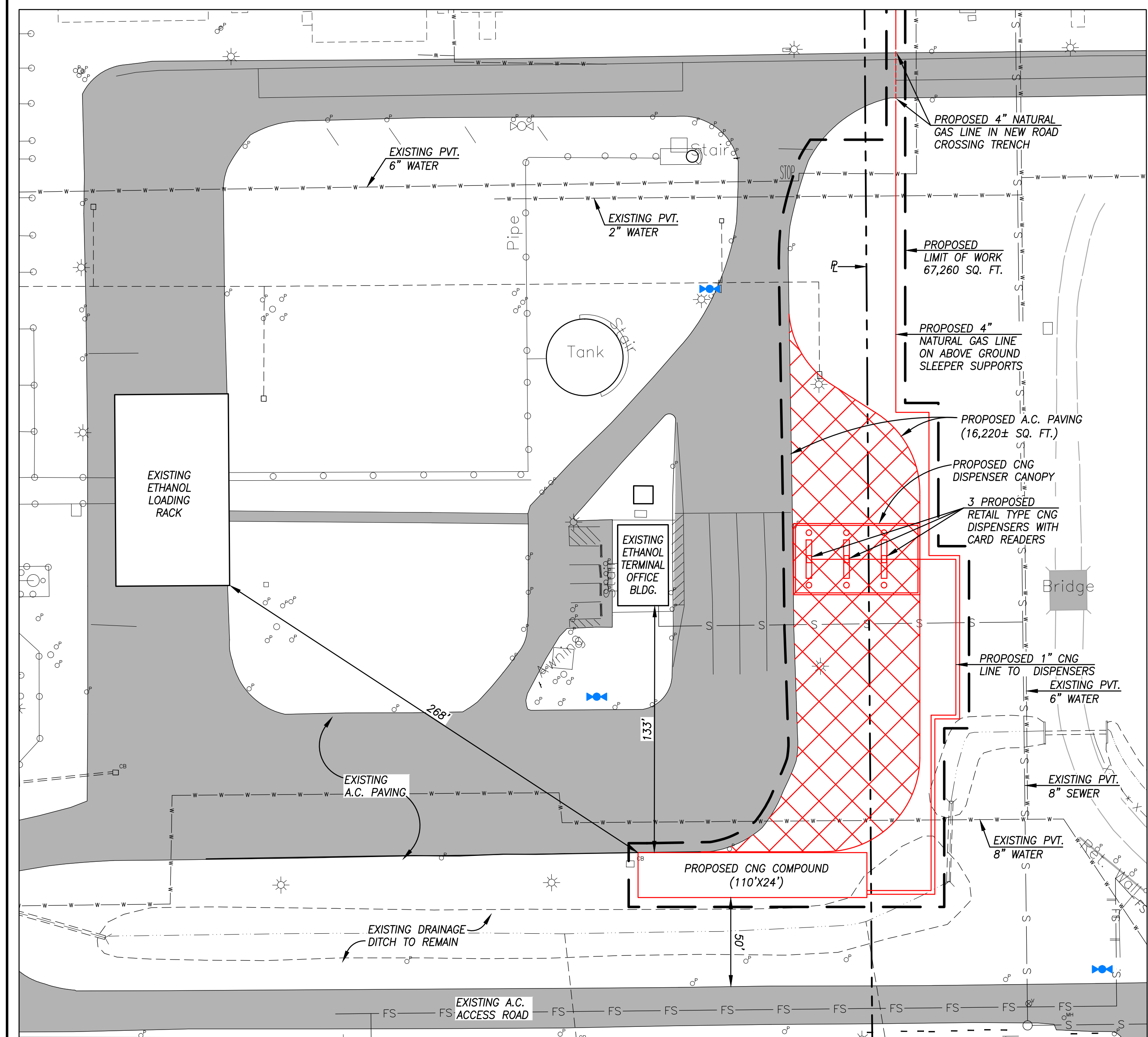
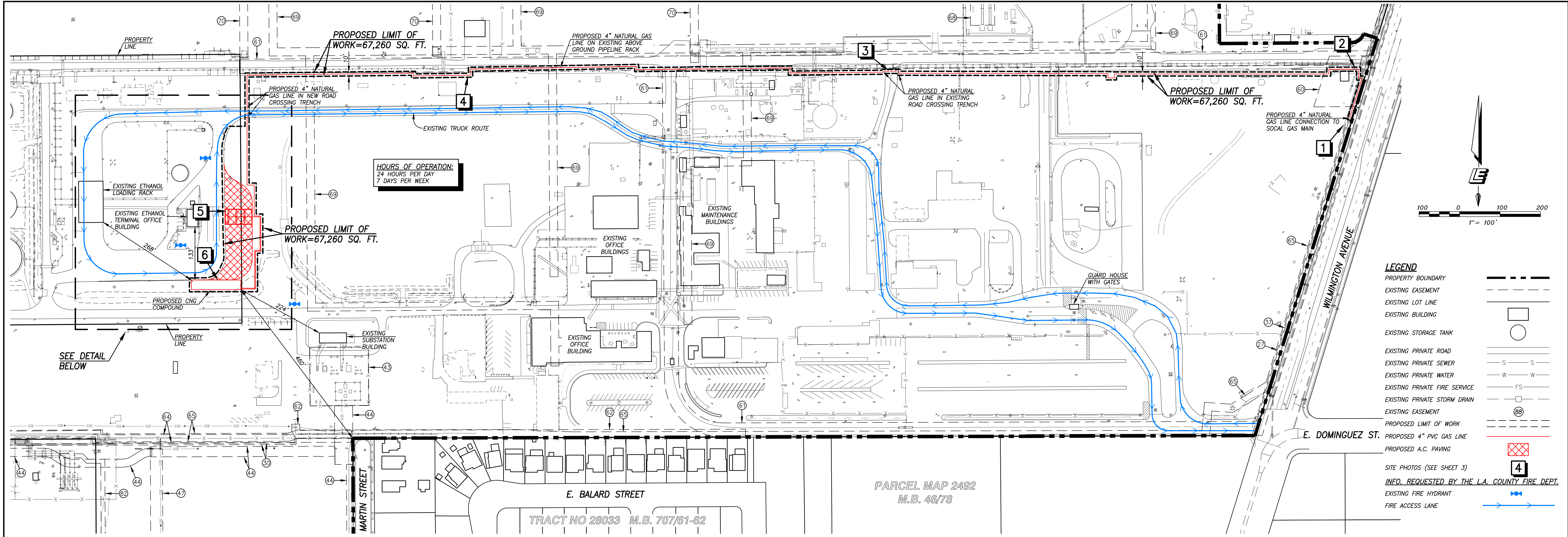

EXISTING EASEMENTS:

- ITEM NUMBERS REFER TO PRELIMINARY TITLE REPORT PREPARED BY FIRST AMERICAN TITLE COMPANY, FILE NO. MCS-850966-CNG-H011, DATED AUGUST 12, 2020.
- RIGHTS OF ENTRY FOR THE EXCAVATION, CLEANING, AND REPAIR OF WATER CONDUITS REC. IN BOOK 2911, PAGE 1 OF DEEDS. SAID DOCUMENT IS NOT LEGIBLE.
 - EASEMENT FOR WATER AND INCIDENTAL PURPOSES TO THE LOS ANGELES COUNTY FLOOD CONTROL DISTRICT, REC. IN BOOK 7016, PAGE 240, O.R. SAID EASEMENT IS BLANKET IN NATURE AND NOT PLOTTABLE.
 - EASEMENT FOR PIPES AND INCIDENTAL PURPOSES TO THE DOMINGUEZ WATER COMPANY, REC. IN BOOK 1515, PAGE 265, O.R., SAID EASEMENT IS BLANKET IN NATURE AND NOT PLOTTABLE.
 - EASEMENT FOR PIPELINES AND INCIDENTAL PURPOSES TO THE UNION OIL COMPANY OF CALIFORNIA, REC. IN BOOK 2725, PAGE 297, O.R.
 - EASEMENT FOR PIPELINE AND INCIDENTAL PURPOSES TO THE UNION OIL CO. OF CALIFORNIA, REC. IN BOOK 2754, PAGE 181, O.R.
 - EASEMENT FOR PIPE LINES AND INCIDENTAL PURPOSES TO THE UNION OIL CO. OF CALIFORNIA, REC. IN BOOK 2774, PAGE 295, O.R., SAID EASEMENT DOES NOT AFFECT THE PROPERTY IN QUESTION.
 - EASEMENT FOR THREE PIPE LINES TO THE UNION OIL CO. OF CALIFORNIA, REC. IN BOOK 3118, PAGE 248, O.R., SAID EASEMENT DOES NOT AFFECT PROPERTY IN QUESTION.
 - EASEMENT FOR PIPE LINES AND INCIDENTAL PURPOSES TO THE SHELL COMPANY OF CALIFORNIA, REC. IN BOOK 3405, PAGE 391, O.R. SAID EASEMENT DOES NOT AFFECT PROPERTY IN QUESTION.
 - EASEMENT FOR PIPELINE AND INCIDENTAL PURPOSES TO THE SHELL COMPANY OF CALIFORNIA, REC. SEPTEMBER 18, 1924 IN BOOK 3442, PAGE 208, O.R.
 - EASEMENT FOR RIGHT OF WAY AND INCIDENTAL PURPOSES TO THE UNION OIL COMPANY, REC. IN BOOK 4045, PAGE 239, O.R., SAID DOCUMENT IS NOT LEGIBLE.
 - EASEMENT FOR WATER LINE AND INCIDENTAL PURPOSES TO THE DOMINGUEZ WATER CO., REC. IN BOOK 4585, PAGE 329, O.R.
 - EASEMENT FOR PIPELINES AND INCIDENTAL PURPOSES, REC. IN BOOK 5658, PAGE 69, O.R.
 - EASEMENT FOR PIPELINES AND INCIDENTAL PURPOSES, REC. IN BOOK 5913, PAGE 10, O.R.
 - EASEMENT FOR WATER PIPELINE PURPOSES TO GREGORIO AND SUSANA DEL AMO, REC. OCTOBER 4, 1926 IN BOOK 6105, PAGE 75, O.R.
 - EASEMENT FOR PIPE LINES AND INCIDENTAL PURPOSES TO THE SHELL OIL COMPANY, REC. JUNE 17, 1932 IN BOOK 11591, PAGE 336, O.R.
 - EASEMENT FOR RIGHT OF WAY AND PIPELINES TO GENERAL PETROLEUM CORPORATION OF CALIFORNIA, REC. IN BOOK 18969, PAGE 195, O.R.
 - EASEMENT FOR PIPE LINES AND INCIDENTAL PURPOSES TO THE DEFENSE PLANT CORPORATION, REC. AUGUST 14, 1943 IN BOOK 20222, PAGE 50, O.R.
 - EASEMENT FOR PIPE LINE AND INCIDENTAL PURPOSES TO THE SHELL OIL COMPANY, REC. NOVEMBER 7, 1945 IN BOOK 22498, PAGE 31, O.R.
 - EASEMENT TO THE SHELL OIL COMPANY DESCRIBED IN THE DOCUMENT ENTITLED "AGREEMENT" REC. IN BOOK 23933, PAGE 287, O.R.
 - EASEMENT FOR POLE LINES AND INCIDENTAL PURPOSES TO SOUTHERN CALIFORNIA EDISON COMPANY, REC. OCTOBER 3, 1966 AS INSTRUMENT NO. 5129 OF OFFICIAL RECORDS. BY AND BETWEEN SHELL OIL COMPANY, A CORPORATION AND SOUTHERN CALIFORNIA GAS COMPANY.
 - EASEMENT FOR PIPE LINES AND INCIDENTAL PURPOSES, REC. SEPTEMBER 17, 1957 AS INST. NO. 3736 IN BOOK 55626, PAGE 218, O.R., SAID DOCUMENT IS NOT LEGIBLE.
 - EASEMENT FOR PIPE LINES AND INCIDENTAL PURPOSES TO THE SHELL OIL COMPANY, REC. FEBRUARY 4, 1965 AS INST. NO.S 2867, 2868, 2869, 2870 AND 2871, ALL OF O.R.
 - EASEMENT FOR PUBLIC UTILITIES AND INCIDENTAL PURPOSES TO THE COUNTY OF LOS ANGELES, REC. FEBRUARY 24, 1966 AS INST. NO. 3333, O.R.
 - THE TERMS AND PROVISIONS CONTAINED IN THE DOCUMENT ENTITLED "AGREEMENT" RECORDED NOVEMBER 9, 1966 AS INSTRUMENT NO. 5129 OF OFFICIAL RECORDS. BY AND BETWEEN SHELL OIL COMPANY, A CORPORATION AND SOUTHERN CALIFORNIA GAS COMPANY.
 - EASEMENT FOR PIPELINES AND INCIDENTAL PURPOSES TO THE UNION OIL COMPANY OF CALIFORNIA, REC. JUNE 25, 1968 AS INST. NO. 3622 IN BOOK D4045, PAGE 239, O.R.

- EASEMENT FOR RIGHT OF WAY FOR ELECTRICAL LINES TO SOUTHERN CALIFORNIA EDISON, REC. JUNE 10, 1969 AS INST. NO. 3018 IN BOOK D4397, PAGE 363, O.R.
- EASEMENT FOR TWO PIPE LINES AND INCIDENTAL PURPOSES TO UNION OIL COMPANY OF CALIFORNIA, REC. AUGUST 13, 1969 AS INST. NO. 2797, O.R., SAID EASEMENT DOES NOT AFFECT THE PROPERTY IN QUESTION.
- EASEMENT FOR PUBLIC STREET, ROAD OR HIGHWAY AND INCIDENTAL PURPOSES TO THE CITY OF CARSON, REC. DECEMBER 1, 1972 AS INST. NO. 3826, O.R. (THE LEGAL DESCRIPTION HAS A PROBABLE ERROR IN DESCRIBING PART A, PLOTTED PER PROBABLE INTENT.)
- EASEMENT FOR FIXTURES AND INCIDENTAL PURPOSES TO SOUTHERN CALIFORNIA EDISON, REC. JULY 17, 1981 AS INST. NO. 81-716624, O.R.
- EASEMENT FOR PUBLIC UTILITIES AND INCIDENTAL PURPOSES TO SOUTHERN CALIFORNIA EDISON, REC. JULY 17, 1981 AS INST. NO. 81-716625, REC. OCTOBER 15, 1981 AS INST. NO. 81-1017337, AND REC. NOVEMBER 27, 1990 AS INST. NO. 90-1958834, ALL O.R.
- EASEMENT FOR PUBLIC STREET AND ROAD AND INCIDENTAL PURPOSES TO THE CITY OF CARSON, REC. MAY 22, 1987 AS INST. NO. 87-815031, O.R.
- EASEMENT FOR PUBLIC UTILITIES AND INCIDENTAL PURPOSES TO SOUTHERN CALIFORNIA EDISON COMPANY, REC. MAY 25, 1988 AS INST. NO. 88-829168, O.R.
- EASEMENT FOR PUBLIC UTILITIES AND INCIDENTAL PURPOSES TO SOUTHERN CALIFORNIA EDISON COMPANY, REC. NOVEMBER 27, 1990 AS INST. NO. 90-1958833, O.R.
- EASEMENT FOR PIPELINE AND INCIDENTAL PURPOSES TO SHELL CALIFORNIA PIPELINE COMPANY, REC. JULY 9, 1996 AS INST. NO. 96-1080985, O.R., SAID EASEMENT IS NOT PLOTTABLE.
- EASEMENT FOR PIPELINES TO UNION OIL COMPANY, REC. JULY 21, 1997 AS INST. NO. 97-1093673, O.R. SAID EASEMENT IS BLANKET IN NATURE AND NOT PLOTTABLE.
- EASEMENT FOR PIPELINES TO UNION OIL COMPANY, REC. AUGUST 21, 1997 AS INST. NO. 97-1300146, O.R. SAID EASEMENT IS BLANKET IN NATURE AND NOT PLOTTABLE.
- EASEMENT FOR STORM WATER SURFACE DRAINAGE SYSTEM TO EQUILON ENTERPRISES, REC. NOVEMBER 13, 2000 AS INST. NO. 00-1770632, O.R. SAID EASEMENT IS BLANKET IN NATURE AND NOT PLOTTABLE.
- EASEMENT FOR STORM WATER DETENTION AND SURFACE DRAINAGE SYSTEM TO SHELL OIL COMPANY, REC. NOVEMBER 13, 2000 AS INST. NO. 00-1770633, O.R. SAID EASEMENT IS BLANKET IN NATURE AND NOT PLOTTABLE.
- EASEMENT FOR STORM WATER DETENTION AND SURFACE DRAINAGE SYSTEM TO SHELL OIL COMPANY, REC. NOVEMBER 13, 2000 AS INST. NO. 00-1770634, O.R. SAID EASEMENT IS BLANKET IN NATURE AND NOT PLOTTABLE.
- EASEMENT FOR PETROLEUM PIPELINES TO EQUILON ENTERPRISES, REC. NOVEMBER 13, 2000 AS INST. NO. 00-1770635, O.R. SAID EASEMENT IS BLANKET IN NATURE AND NOT PLOTTABLE.
- EASEMENT FOR ELECTRIC LINES TO EQUILON ENTERPRISES, REC. NOVEMBER 13, 2000 AS INST. NO. 00-1770636, O.R.
- EASEMENT FOR FIRE PROTECTION FACILITY TO EQUILON ENTERPRISES REC. NOVEMBER 13, 2000 AS INST. NO. 00-1770637, O.R.
- EASEMENT FOR ACCESS ROADS TO EQUILON ENTERPRISES REC. NOVEMBER 13, 2000 AS INST. NO. 00-1770638, O.R.
- EASEMENT FOR PETROLEUM PIPELINES TO EQUILON ENTERPRISES REC. NOVEMBER 13, 2000 AS INST. NO. 00-1770639, O.R.
- EASEMENT FOR PETROLEUM PIPELINES TO EQUILON ENTERPRISES REC. NOVEMBER 13, 2000 AS INST. NO. 00-1770640, O.R.
- EASEMENT FOR PETROLEUM PIPELINES TO EQUILON ENTERPRISES REC. NOVEMBER 13, 2000 AS INST. NO. 00-1770641, O.R.
- EASEMENT FOR PETROLEUM PIPELINES TO EQUILON ENTERPRISES REC. NOVEMBER 13, 2000 AS INST. NO. 00-1770642, O.R.
- EASEMENT FOR PETROLEUM PIPELINES TO EQUILON ENTERPRISES REC. NOVEMBER 13, 2000 AS INST. NO. 00-1770643, O.R.
- EASEMENT FOR RAILROAD TRACKS TO SHELL OIL COMPANY REC. NOVEMBER 13, 2000 AS INST. NO. 00-1770644, O.R.
- EASEMENT FOR RAILROAD TRACKS TO EQUILON ENTERPRISES REC. NOVEMBER 13, 2000 AS INST. NO. 00-1770645, O.R.
- EASEMENT FOR SEWER TO EQUILON ENTERPRISES REC. NOVEMBER 13, 2000 AS INST. NO. 00-1770646, O.R.
- EASEMENT FOR FIREWATER SYSTEM TO EQUILON ENTERPRISES REC. NOVEMBER 13, 2000 AS INST. NO. 00-1770647, O.R.
- EASEMENT FOR PIPELINE METERING STATION TO CHEVRON U.S.A. INC. REC. FEBRUARY 13, 2001 AS INST. NO. 01-0236153, O.R.
- AN EASEMENT FOR PUBLIC ROAD AND HIGHWAY AND INCIDENTAL PURPOSES IN THE DOCUMENT RECORDED OCTOBER 13, 2004 AS INSTRUMENT NO.04-2631211 OF OFFICIAL RECORDS.
- EASEMENT FOR PETROLEUM PIPELINES TO CRIMSON CALIFORNIA PIPELINE, REC. MAY 25, 2005 AS INST. NO. 05-1228163, O.R. SAID EASEMENT IS BLANKET IN NATURE AND NOT PLOTTABLE.
- EASEMENT FOR PETROLEUM PIPELINES TO CRIMSON CALIFORNIA PIPELINE, REC. MAY 26, 2005 AS INST. NO. 05-1238986, O.R. SAID EASEMENT IS BLANKET IN NATURE AND NOT PLOTTABLE.
- EASEMENT FOR PETROLEUM PIPELINES TO CRIMSON CALIFORNIA PIPELINE, REC. MAY 26, 2005 AS INST. NO. 05-1238988, O.R. SAID EASEMENT IS BLANKET IN NATURE AND NOT PLOTTABLE.
- EASEMENT FOR PETROLEUM PIPELINES TO CRIMSON CALIFORNIA PIPELINE, REC. MAY 26, 2005 AS INST. NO. 05-1238989, O.R. SAID EASEMENT IS BLANKET IN NATURE AND NOT PLOTTABLE.
- EASEMENT FOR PETROLEUM PIPELINES TO CRIMSON CALIFORNIA PIPELINE, REC. MAY 26, 2005 AS INST. NO. 05-1238992, O.R. SAID EASEMENT IS BLANKET IN NATURE AND NOT PLOTTABLE.
- EASEMENT FOR PETROLEUM PIPELINES TO CRIMSON CALIFORNIA PIPELINE, REC. MAY 26, 2005 AS INST. NO. 05-1238993, O.R. SAID EASEMENT IS BLANKET IN NATURE AND NOT PLOTTABLE.
- THE TERMS, PROVISIONS AND EASEMENT(S) CONTAINED IN THE DOCUMENT ENTITLED "ASSIGNMENT OF PIPELINE RIGHTS OF WAY" RECORDED MAY 14, 2007 AS INSTRUMENT NO. 20071162482 OF OFFICIAL RECORDS.
- THE TERMS, PROVISIONS AND EASEMENT(S) CONTAINED IN THE DOCUMENT ENTITLED "PARTIAL ASSIGNMENT OF PIPELINE RIGHTS OF WAY" RECORDED MAY 16, 2007 AS INSTRUMENT NO. 20071189537 OF OFFICIAL RECORDS.
- THE TERMS, PROVISIONS AND EASEMENT(S) CONTAINED IN THE DOCUMENT ENTITLED "ASSIGNMENT OF REFINERY PIPELINE RIGHTS OF WAY" RECORDED MAY 16, 2007 AS INSTRUMENT NO. 20071189538 OF OFFICIAL RECORDS
- EASEMENT FOR PETROLEUM PIPELINES TO TESORO REFINING AND MARKETING CORP. REC. OCTOBER 16, 2008 AS INST. NO. 2008-81846321, O.R.
- THE TERMS AND PROVISIONS CONTAINED IN THE DOCUMENT ENTITLED "RECIPROCAL ACCESS AGREEMENT" RECORDED JULY 28, 2020 AS INSTRUMENT NO. 20200843993 OF OFFICIAL RECORDS.

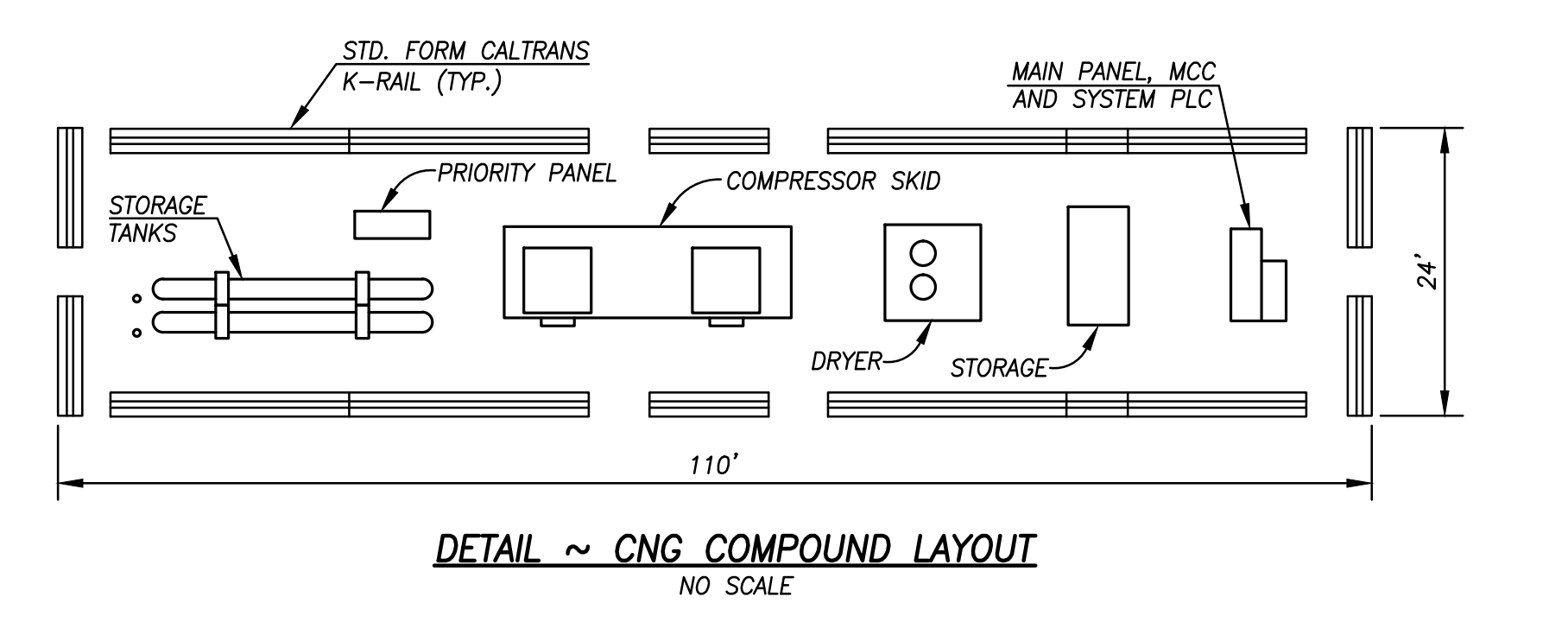

Leppert Engineering CORPORATION
5190 Governor Drive, Suite 205, San Diego, Ca. 92122-2648
Phone: (619) 597-2001 Fax: (619) 597-2009

**CONDITIONAL USE PERMIT FOR:
SHELL CARSON TERMINAL - COMPRESSED NATURAL GAS FACILITY
CARSON, CALIFORNIA**

NO.	DATE
1	10/27/20
2	1/14/21
3	2/18/21
4	
5	
6	
7	
8	
9	
10	

DATE: 1/14/21
SCALE: AS SHOWN
DRAWN: MO
JOB: CA1.01-31.08
SHEET: 2
OF 3 SHEETS

SITE PLAN

SITE PHOTOS



1 APPROXIMATE LOCATION OF CONNECTION TO SOCAL NATURAL GAS MAIN NEAR WILMINGTON, VIEW NORTH



2 EASTERN TERMINUS OF EXISTING PIPE RACK NEAR WILMINGTON AVENUE, VIEW EAST



3 EXISTING DRIVEWAY CROSSING IN A PRECAST TRENCH WITH GRATE COVERING, VIEW EAST



4 EXISTING EAST/WEST PIPE RACK THAT WILL CONVEY THE 4-INCH NATURAL GAS LINE, VIEW NORTH



5 LOCATION OF TWO CNG DISPENSERS AND ADDITIONAL PAVEMENT, VIEW EAST



6 LOCATION OF CNG COMPOUND, VIEW SOUTHEAST

CNG EQUIPMENT PHOTOS



TYPICAL CNG SYSTEM COMPOUND, 2 COMPRESSORS AND 3 TANKS



CNG DRYER, LOCATED IN THE CNG SYSTEM COMPOUND



TYPICAL CNG DISPENSER

TYPICAL SECTIONS OF EXISTING ADJACENT STREETS

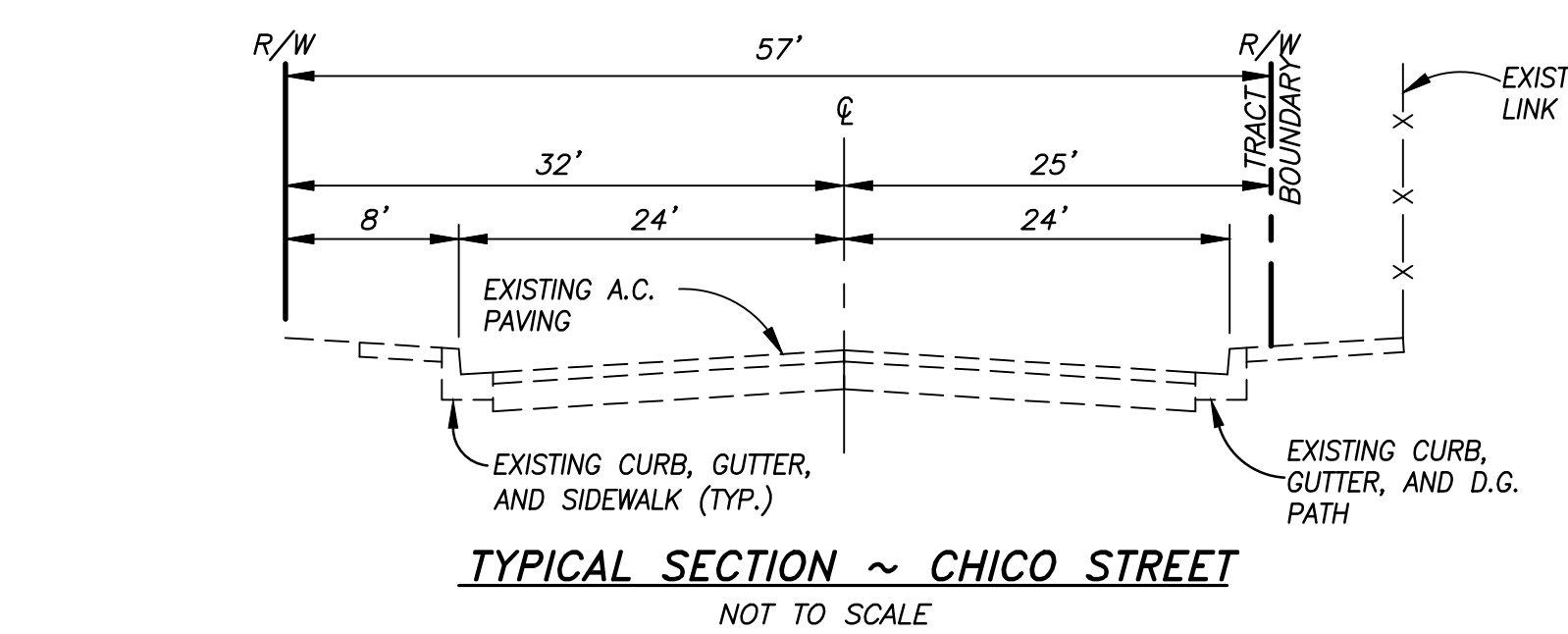
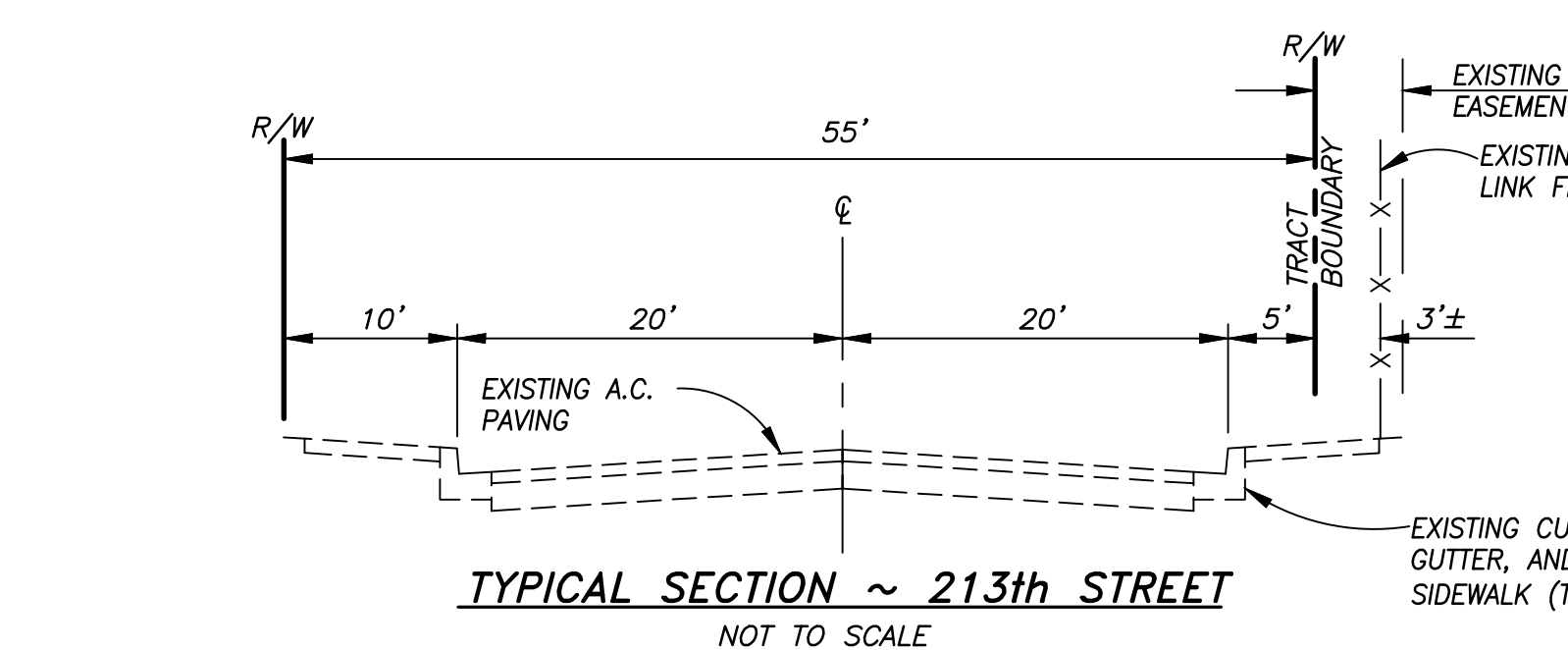
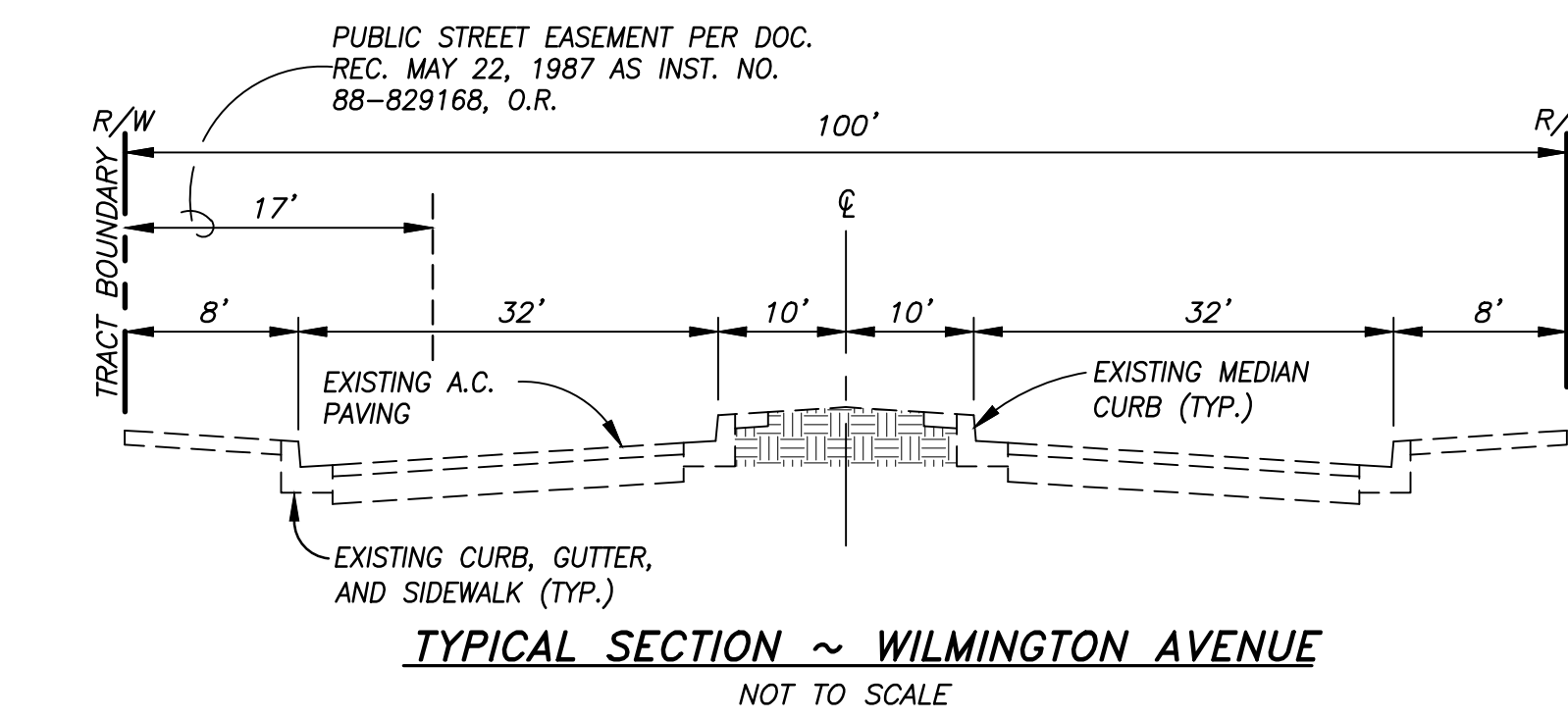
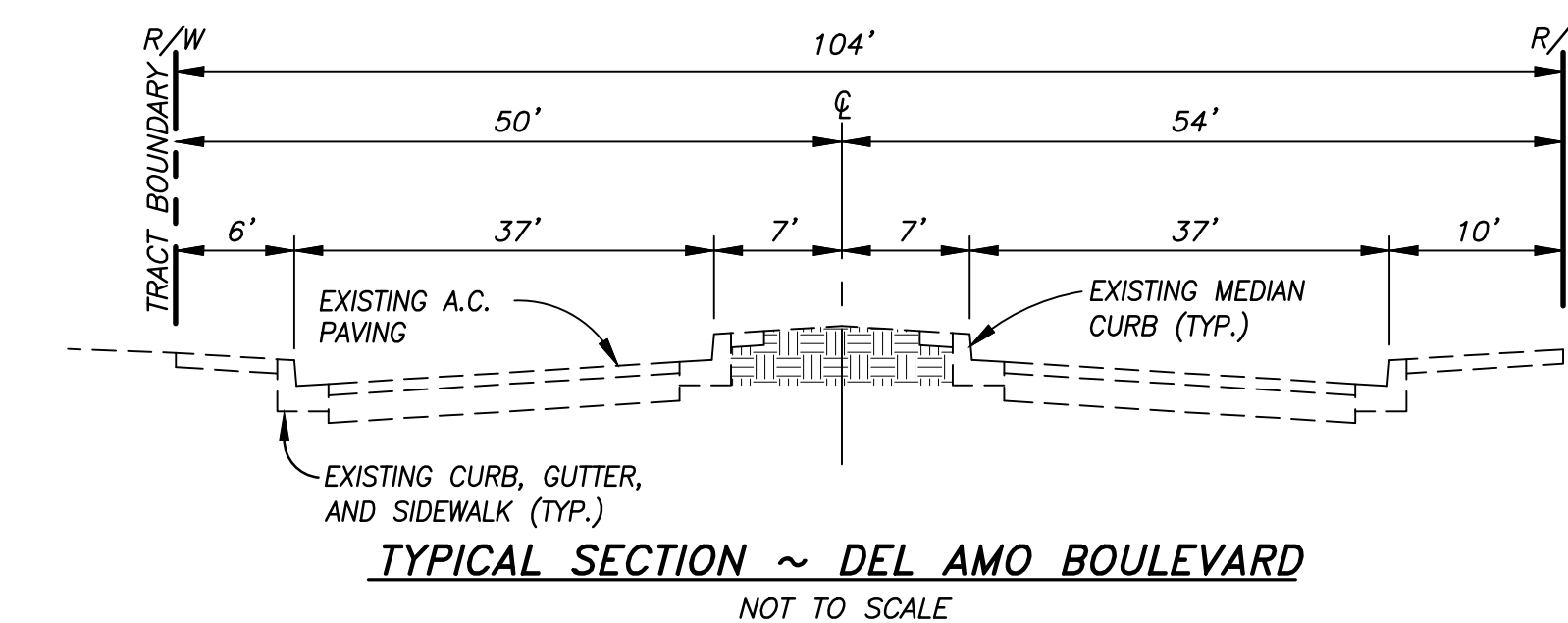
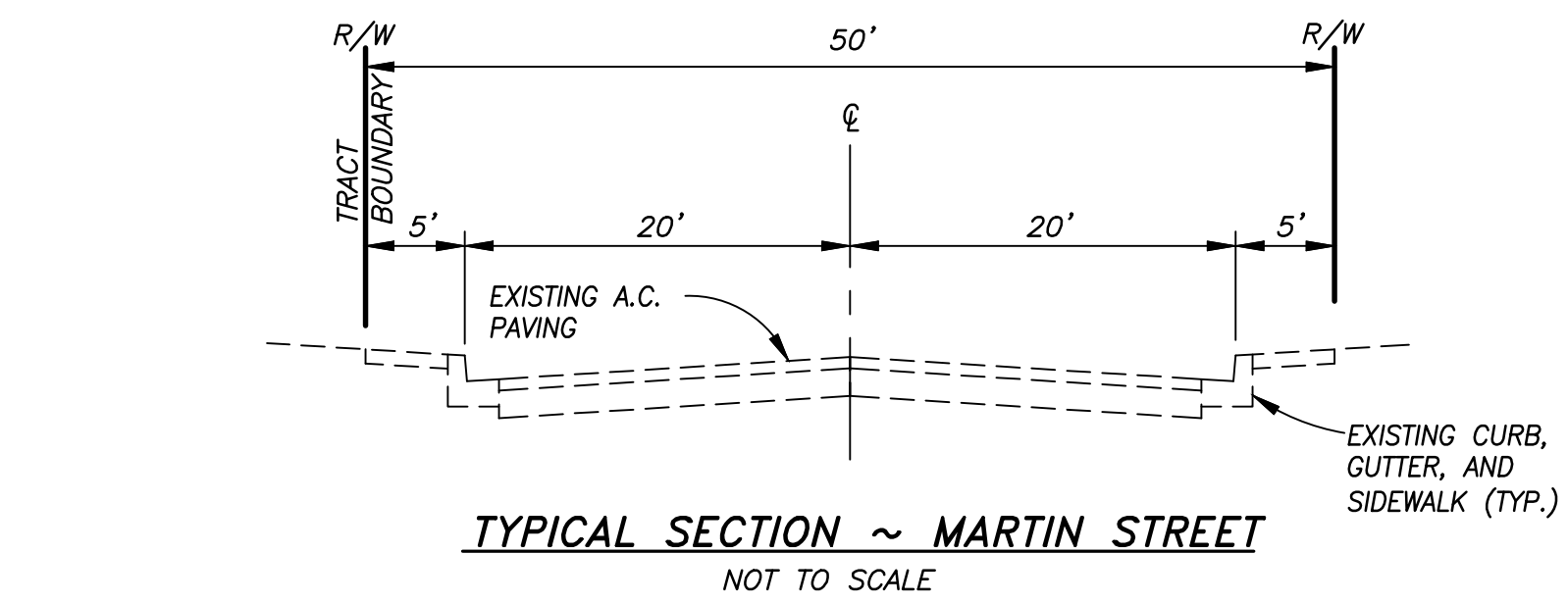
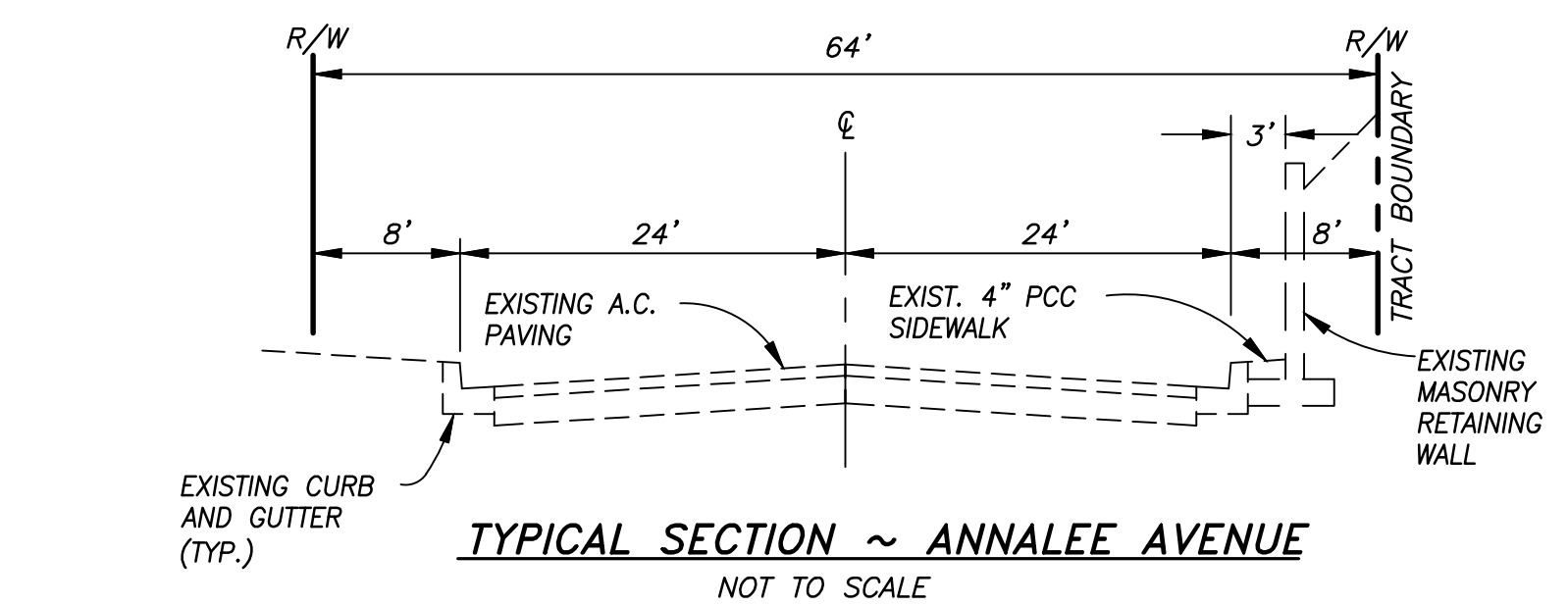

REVISIONS	
NO.	DATE
1	10/27/20
2	1/14/21
3	2/18/21
4	
5	
6	
7	
8	
9	
10	
DATE 1/14/21	
SCALE AS SHOWN	
DRAWN MO	
JOB CA1.01-31.08	
SHEET	
3	
OF 3 SHEETS	