



City of Carson

Report to Mayor and City Council

November 6, 2013
New Business Consent

SUBJECT: CONSIDERATION OF RESOLUTION NO. 13-105, GRANTING CONSENT AND JURISDICTION TO THE COUNTY OF LOS ANGELES IN THE MATTER OF COUNTY LIGHTING MAINTENANCE DISTRICT 1697 AND COUNTY LIGHTING DISTRICT LLA-1, CARSON ZONE, CITY OF CARSON TRACT NO. 71748 AND L 049-2012; AND RESOLUTION NOS. 13-106 AND 13-107, APPROVING AND ACCEPTING THE NEGOTIATED EXCHANGE OF PROPERTY TAX REVENUES RESULTING FROM ANNEXATION OF TRACT NO. 71748 AND L 049-2012 TO COUNTY LIGHTING MAINTENANCE DISTRICT 1697, RESPECTIVELY

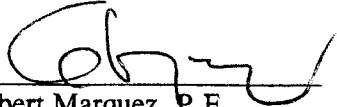
Submitted by Gilbert Marquez, P.E.
Acting Director of Public Works/City Engineer

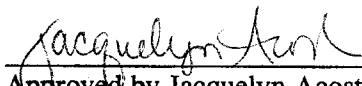
Approved by Jacquelyn Acosta
Acting City Manager

I. SUMMARY

The County of Los Angeles Department of Public Works has submitted a resolution to the City of Carson granting consent and jurisdiction to the County of Los Angeles to annex an area of the City to Lighting Maintenance District (CLMD) 1697 and County Lighting District LLA-1 (Exhibit No. 1). Joint resolutions between the County of Los Angeles and the City of Carson (and various other taxing agencies) approving and accepting the negotiated exchange of property tax revenues resulting from the annexation of Tract No. 71748 (Exhibit No. 2) and L 049-2012 (Exhibit No. 3) is also required. The County of Los Angeles is requesting that the City adopt these resolutions to reflect the proposed annexation as it applies to locations within the City.

II. RECOMMENDATION

TAKE the following actions:

1. WAIVE further reading and ADOPT Resolution No. 13-105, "A RESOLUTION OF THE CITY COUNCIL OF THE CITY OF CARSON, CALIFORNIA, GRANTING CONSENT AND JURISDICTION TO THE COUNTY OF LOS ANGELES IN THE MATTER OF COUNTY LIGHTING MAINTENANCE DISTRICT 1697 AND COUNTY LIGHTING DISTRICT LLA-1, CARSON ZONE, CITY OF CARSON TRACT NO. 71748 AND L 049-2012."
2. WAIVE further reading and ADOPT Resolution Nos. 13-106, "A JOINT RESOLUTION OF THE BOARD OF SUPERVISORS OF THE COUNTY OF LOS ANGELES; THE BOARD OF TRUSTEES OF THE GREATER LOS ANGELES COUNTY VECTOR CONTROL DISTRICT; THE BOARD OF DIRECTORS OF THE COUNTY SANITATION DISTRICT

//

NO. 8 OF LOS ANGELES COUNTY (COUNTY SANITATION DISTRICT NO. 8); THE CITY COUNCIL OF THE CITY OF CARSON, CALIFORNIA; AND THE BOARD OF DIRECTORS OF THE WATER REPLENISHMENT DISTRICT OF SOUTHERN CALIFORNIA APPROVING AND ACCEPTING THE NEGOTIATED EXCHANGE OF PROPERTY TAX REVENUES RESULTING FROM ANNEXATION OF TRACT NO. 71748 TO COUNTY LIGHTING MAINTENANCE DISTRICT 1697.”

3. WAIVE further reading and ADOPT Resolution Nos. 13-107, “A JOINT RESOLUTION OF THE BOARD OF SUPERVISORS OF THE COUNTY OF LOS ANGELES; THE BOARD OF TRUSTEES OF THE GREATER LOS ANGELES COUNTY VECTOR CONTROL DISTRICT; THE BOARD OF DIRECTORS OF THE COUNTY SANITATION DISTRICT NO. 8 OF LOS ANGELES COUNTY (COUNTY SANITATION DISTRICT NO. 8); THE CITY COUNCIL OF THE CITY OF CARSON, CALIFORNIA; AND THE BOARD OF DIRECTORS OF THE WATER REPLENISHMENT DISTRICT OF SOUTHERN CALIFORNIA APPROVING AND ACCEPTING THE NEGOTIATED EXCHANGE OF PROPERTY TAX REVENUES RESULTING FROM ANNEXATION OF L 049-2012 TO COUNTY LIGHTING MAINTENANCE DISTRICT 1697.”

III. ALTERNATIVES

1. DENY the proposed annexation. However, denying the proposed annexation will obligate the City to pay 100% of the operation and maintenance costs of the street lights. The City needs to adopt the resolutions in order for the County to proceed with the annexation procedures.
2. TAKE another action the City Council deems appropriate.

IV. BACKGROUND

As part of the conditions of approval established by the City for various developments within the City, developers have been required to annex their properties to CLMD 1697 and County Lighting District LLA-1, allowing the County to provide funds for the operation and maintenance of existing street lights in the public right-of-way. Currently, these areas, located at 20945 S. Wilmington Avenue (Shell property) (Exhibit No. 4) and 18026 Broadway (single lot development) (Exhibit No. 5), are being processed by the County of Los Angeles Department of Public Works for annexation to CLMD 1697 and County Lighting District LLA-1. Since these areas are within the boundary of the City of Carson, permission from the City is required to accomplish annexation.

As a result of the changes in the annexation procedures approved by County Counsel, the City is required to adopt a negotiated tax exchange resolution in order to proceed with annexation into the lighting district. For all new annexations into a County administered CLMD, the procedure requires processing the exchange of property tax revenues with all non-exempt taxing agencies, including the City of Carson. Under Section 99.01 of the Revenue and Taxation (R&T) Code, special districts providing new services to an area as a result of a jurisdictional change are entitled to a share of the annual tax increment generated in the area being annexed. CLMD 1697 is defined under Section 95(m) of the R&T Code as a special district. CLMD 1697's share of the annual tax increment is to be taken from all of the other local taxing agencies providing services within the annexed area, with the exception of school entities which are exempted by law. The approving bodies of the local taxing agencies providing services are the following: The Board of Supervisors of the County of Los Angeles; the Board of Trustees of the greater Los Angeles County Vector Control District; the Board of Directors of the County Sanitation District No. 8 of Los Angeles County (County Sanitation District No. 8); the City Council of the City of Carson, California; and the Board of Directors of the Water Replenishment District of Southern California.

This annexation will formalize the City's obligation to allocate a portion of its property tax revenue to CLMD 1697, and Los Angeles County's obligation to provide funds for the operation and maintenance of the street lights to be installed. Currently, the property tax share percentage from Tract No. 71748 is 7% and from L 049-2012 is 6.74% in the City of Carson. From this tax share percentage, the City would allocate 0.08% from Tract No. 71748 and 0.07% from L 049-2012, to CLMD 1697. The City's net property tax share would then be 6.92% from Tract No. 71748 and 6.67% from L 049-2102. Monetarily speaking, a \$10,000.00 increment in assessed valuation of a parcel means that the parcel will pay an additional \$100.00 in property taxes; of which the City will receive \$6.92 and CLMD 1697 will receive \$0.08 from Tract No. 71748; the City will receive \$6.67 and CLMD 1697 will receive \$0.07 from L 049-2012. The City's tax share percentage was calculated using the formula approved by both the Auditor-Controller and the County Counsel. The property tax share percentage for the rest of the agencies providing services is shown on the attached Property Tax Transfer Resolution Worksheets (Exhibit No. 6). In addition, as a result of the July 24, 2012 increase in the street lighting assessment rate adopted by the Board of Supervisors of the County of Los Angeles, each of the two property owners of the area being annexed will be assessed \$35.00 per year for a typical residential lot and \$175.00 per year for a typical commercial lot. This assessment will be levied to the property tax bill received by the property owners every year. This annexation request is standard

procedure and must be completed so that funds can be provided to CLMD 1697 and County Lighting District LLA-1 for the operation and maintenance of the street lights.

The County has prepared joint resolutions between the County of Los Angeles and the City of Carson (and other various taxing agencies) approving and accepting the negotiated exchange of property tax revenues resulting from the annexation of Tract No. 71748 and L 049-2012. It is requested that the City Council adopt these resolutions in order to allow the Board of Supervisors of the County of Los Angeles funding approval to be concurrent with the board's approval of the annexation itself (Exhibit No. 7).

City staff concurs with the recommendation of the County of Los Angeles Department of Public Works and recommends that the City Council adopt these resolutions.

V. FISCAL IMPACT

Recently, the Board of Supervisors of the County of Los Angeles adopted a resolution increasing the annual base assessment rate to \$35.00 per unit. The current assessment per year for a typical residential lot is \$35.00. Assessment for commercial properties is proportionally higher. The City will contribute 0.08% from Tract No. 71748 and 0.07% from L 049-2012 of the property tax share from the annexed assessor's parcels to CLMD 1697. The remaining balance would be transmitted to the City's general fund.

VI. EXHIBITS

1. Resolution No. 13-105. (pgs. 6-9)
2. Resolution No. 13-106. (pgs. 10-15)
3. Resolution No. 13-107. (pgs. 16-19)
4. Location Map. (pg. 20)
5. Location Map. (pg. 21)
6. Property Tax Transfer Resolution Worksheets. (pgs. 22-27)
7. Letter from Los Angeles County / Traffic and Lighting Division, dated October 17, 2013. (pgs. 28-29)

Prepared by: Gilbert M. Marquez, P.E., Acting Director of Public Works

\\Carson_nas\devsvrs\ENGINEERING DIVISION\STREET LIGHTING DISTRICT\L 049-2012 AND TRACT NO. 71748\11-06-13 CC Agenda_Street Lighting District_L 049-2012_FINAL.docx

TO Rev10-14-2013

Reviewed by:

City Clerk	City Treasurer
Administrative Services	Public Works
Community Development	Community Services

Action taken by City Council

Date_____ Action_____

RESOLUTION NO. 13-105

A RESOLUTION OF THE CITY COUNCIL OF THE CITY OF CARSON, CALIFORNIA, GRANTING CONSENT AND JURISDICTION TO THE COUNTY OF LOS ANGELES IN THE MATTER OF COUNTY LIGHTING MAINTENANCE DISTRICT 1697 AND COUNTY LIGHTING DISTRICT LLA-1, CARSON ZONE, CITY OF CARSON TRACT NO. 71748 AND L 049-2012

WHEREAS, the Board of Supervisors of the county of Los Angeles is about to commence proceedings under Divisions 7 and 15 of the Streets and Highways Code of the state of California for the annexation of this territory to the County Lighting Maintenance District 1697 and County Lighting District LLA-1, Carson Zone; and

WHEREAS, the street lights will be installed in the proposed annexation territory known as Tract No. 71748 located at 20945 S. Wilmington Ave. and L 049-2012 located at 18026 Broadway in the City of Carson; and

WHEREAS, all of the land included in the proposed annexation lies within the boundary of the City of Carson.

NOW, THEREFORE, be it determined by the City Council of the City of Carson, California, that:

Section 1. The public interest, convenience, and necessity require the maintenance of a street lighting system located within said territory as shown on the map of the proposed annexation area to County Lighting Maintenance District 1697 and County Lighting District LLA-1, Carson Zone, attached and on file in the office of the County of Los Angeles Department of Public Works..

Section 2. This City Council hereby consents to the annexation of said territory as shown on the attached maps (Attachment A), and included within the boundary of said annexation and lying within the boundary of the City of Carson.

Section 3. This City Council hereby finds and determines that the land included within the boundary of the proposed annexation lying within the boundary of the City of Carson, will be benefited by the proposed annexation, and hereby consents to the inclusion of said land within the proposed annexation and to the assessment thereof.

Section 4. The consent of the City of Carson is hereby given to the commencement of the proceedings for said annexation to County Lighting Maintenance District 1697 and County Lighting District Landscaping and Lighting Act-1, Carson Zone, by the Board of Supervisors of the county of Los Angeles, and to the exercise of exclusive jurisdiction of said Board of Supervisors over all proceedings necessary thereto for the purpose of consummating the same, all in accordance with the provisions of Divisions 7 and 15 of the California Streets and Highways Code.

[MORE]

EXHIBIT NO. 01



Section 5. The Clerk of the City Council is hereby directed to certify and deliver two copies of this resolution to the County of Los Angeles Department of Public Works.

Section 6. The City Clerk shall certify to the passage of this resolution by the City Council of the City of Carson, and shall cause the same to be posted in three conspicuous places in the City of Carson, and it shall thereupon take effect.

PASSED, APPROVED, and ADOPTED this ____ day of _____, 2013.

Mayor Jim Dear

ATTEST:

City Clerk Donesia L. Gause, CMC

APPROVED AS TO FORM:

City Attorney



TRACT NO. 71748

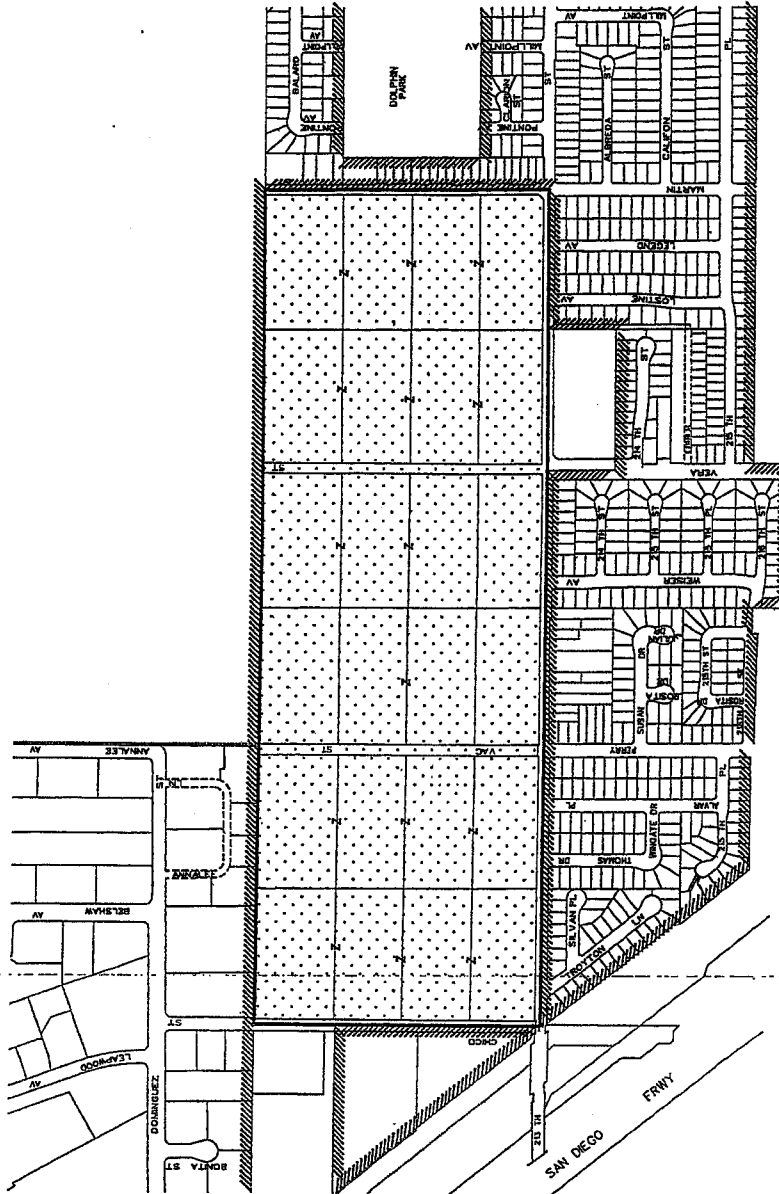

LEGEND

PROPOSED ANNEXATION AREA

EXISTING LIGHTING MAINTENANCE DISTRICT 1697

PROPOSED ANNEXATION TO COUNTY
LIGHTING MAINTENANCE DISTRICT 1697
AND COUNTY LIGHTING DISTRICT LLA-1
(CARSON ZONE)

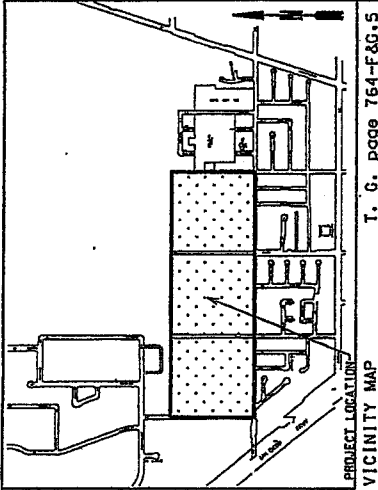

TRA	APN
5475	7325001.003
5479	7325001.004
	7327002.008
	7327002.012
	7327002.013
	7327002.014
	7327002.015
	7327002.016
	7327002.017
	7327002.019
	7327002.021

NOT TO SCALE

LOS ANGELES COUNTY DEPARTMENT OF PUBLIC WORKS
TRAFFIC AND LIGHTING DIVISION
STREET LIGHTING SECTION

CLMD 1697 CITY OF CARSON	
Prepared By TO	Sheet 1 of 1 SUP. DIST. 2
Recommended By <i>M. Phillips</i>	Date <i>2/5/13</i>
Approved By <i>[Signature]</i>	Date <i>2/6/13</i>

L 049-2012

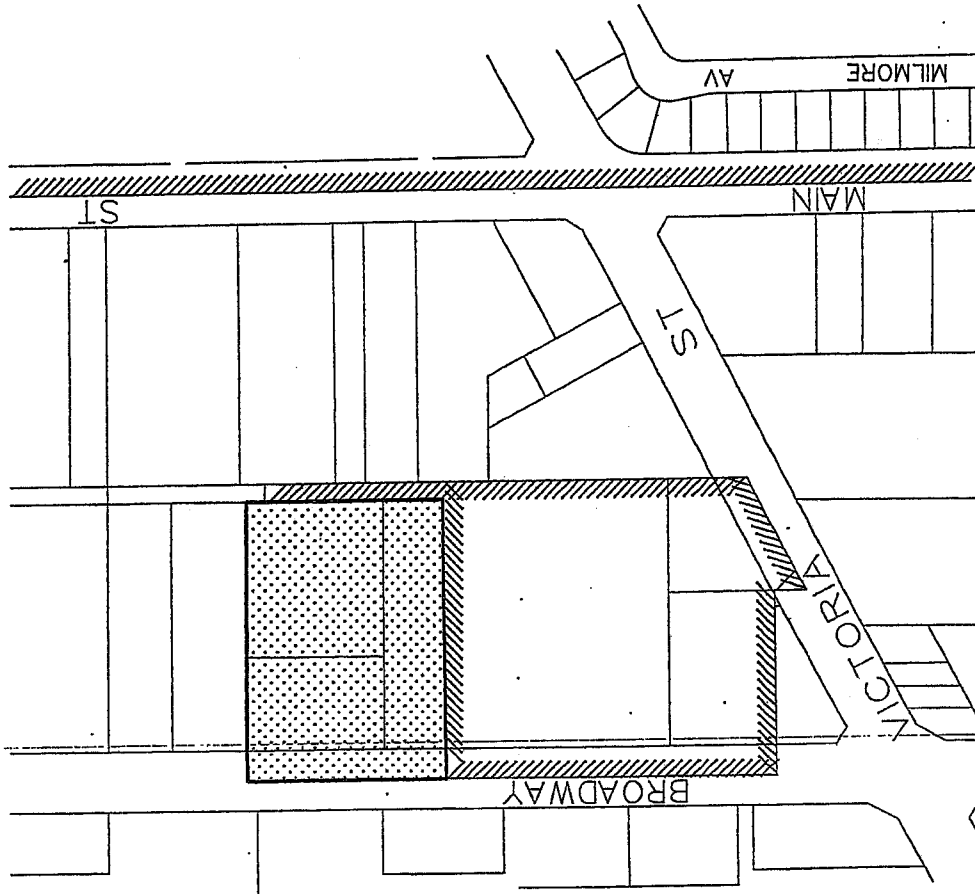

LEGEND

PROPOSED ANNEXATION AREA

EXISTING LIGHTING MAINTENANCE DISTRICT 1697

PROPOSED ANNEXATION TO COUNTY
LIGHTING MAINTENANCE DISTRICT 1697
AND COUNTY LIGHTING DISTRICT LLA-1
(CARSON ZONE)

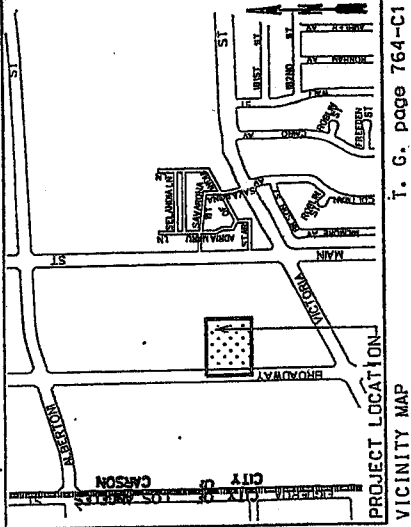

TRA
1183
APN
7339 004 001
7339 004 002
7339 004 003



NOT TO SCALE

LOS ANGELES COUNTY DEPARTMENT OF PUBLIC WORKS
TRAFFIC AND LIGHTING DIVISION
STREET LIGHTING SECTION

CLMD 1697
CITY OF CARSON

Prepared By TD	Sheet 1 of 1	SUP. DIST. 2
Recommended By <i>Franklin</i>	Date <i>7/1/13</i>	
Approved By <i>Gregg</i>	Date <i>2/4/13</i>	

RESOLUTION NO. 13-106

A JOINT RESOLUTION OF THE BOARD OF SUPERVISORS OF THE COUNTY OF LOS ANGELES; THE BOARD OF TRUSTEES OF THE GREATER LOS ANGELES COUNTY VECTOR CONTROL DISTRICT; THE BOARD OF DIRECTORS OF THE COUNTY SANITATION DISTRICT NO. 8 OF LOS ANGELES COUNTY (COUNTY SANITATION DISTRICT NO. 8); THE CITY COUNCIL OF THE CITY OF CARSON, CALIFORNIA; AND THE BOARD OF DIRECTORS OF THE WATER REPLENISHMENT DISTRICT OF SOUTHERN CALIFORNIA APPROVING AND ACCEPTING THE NEGOTIATED EXCHANGE OF PROPERTY TAX REVENUES RESULTING FROM ANNEXATION OF TRACT NO. 71748 TO COUNTY LIGHTING MAINTENANCE DISTRICT 1697

WHEREAS, pursuant to Section 99.01 of the California Revenue and Taxation Code, prior to the effective date of any jurisdictional change that will result in a special district providing one or more services to an area where those services have not previously been provided by any local agency, the special district and each local agency that receives an apportionment of property tax revenue from the area must negotiate an exchange of property tax increment generated in the area subject to the jurisdictional change and attributable to those local agencies; and

WHEREAS, the Board of Supervisors of the county of Los Angeles, acting on behalf of the County Lighting Maintenance District 1697, the Los Angeles County General Fund, the Los Angeles County Library, the Consolidated Fire Protection District of Los Angeles County, the Los Angeles County Flood Control Drainage Improvement District, and the Los Angeles County Flood Control District; the Board of Trustees of the Greater Los Angeles County Vector Control District; the Board of Directors of the County Sanitation District No. 8 of Los Angeles County (County Sanitation District No. 8); the City Council of the City of Carson; and the Board of Directors of the Water Replenishment District of Southern California have determined that the amount of property tax revenue to be exchanged between their respective agencies as a result of the annexation proposal identified as Tract No. 71748 to County Lighting Maintenance District 1697 is as shown on the enclosed Property Tax Transfer Resolution Worksheets (Attachment A).

NOW, THEREFORE, be it determined by the City Council of the City of Carson, California, that:

Section 1. The negotiated exchange of property tax revenues between the County Lighting Maintenance District 1697, and the Los Angeles County General Fund, the Los Angeles County Public Library, the Consolidated Fire Protection District of Los Angeles County, the Los Angeles County Flood Control Drainage Improvement District, the Los Angeles County Flood Control District; the Greater Los Angeles County Vector Control District, the County Sanitation District No. 8, the City of Carson, and the Water Replenishment District of Southern California resulting from the annexation proposal identified as Tract No. 71748 to County Lighting Maintenance District 1697 is approved and accepted.

[MORE]

EXHIBIT NO. 02

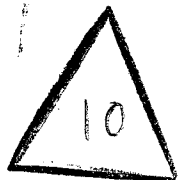

Section 2. For annexation projects within a City of Carson Community Redevelopment Project Area (RPA), County Lighting Maintenance District 1697 will not receive the negotiated share of annual tax increment (ATI) until such time as the affected RPA is terminated for purposes of receiving an ATI.

Section 3. For fiscal years commencing on or after July 1, 2013, or the July 1 after the effective date of this jurisdictional change, whichever is later, the property tax revenue increment generated from the area within Tract No. 71748 (Tax Rate Areas 05475 and 05479) shall be allocated to the affected agencies as indicated in the enclosed Property Tax Transfer Resolution Worksheets.

Section 4. No transfer of property tax revenues other than those specified in Paragraph 3 shall be made as a result of annexation of Tract No. 71748.

Section 5. If at any time after the effective date of this resolution, the calculations used herein to determine initial property tax transfers or the data used to perform those calculations are found to be incorrect, thus producing an improper or inaccurate property tax transfer, the property tax transfer shall be recalculated and the corrected transfer shall be implemented for the next fiscal year, and any amounts of property tax received in excess of that which is proper shall be refunded to the appropriate agency.

PASSED, APPROVED, and ADOPTED this ____ day of _____, 2013.

Mayor Jim Dear

ATTEST:

City Clerk Donesia L. Gause, CMC

APPROVED AS TO FORM:

City Attorney



PROPERTY TAX TRANSFER RESOLUTION WORKSHEET
FISCAL YEAR 2012-2013

DIOR ACAFAN03

ANNEXATION TO: CO LIGHTING MAINT DIST NO 1697
ACCOUNT NUMBER: 019.56
TRA: 05475
EFFECTIVE DATE: 07/01/2013
ANNEXATION NUMBER: TR 71748
PROJECT NAME: TRACT NO. 71748
DISTRICT SHARE: 0.010988070

ACCOUNT #	TAXING AGENCY	CURRENT TAX SHARE	PERCENT	PROPOSED DIST SHARE	ALLOCATED SHARE	ADJUSTMENTS	NET SHARE
001.05	LOS ANGELES COUNTY GENERAL	0.458442053	45.8451 %	0.010988070	0.005037404	-0.005125828	0.453316225
001.20	L.A. COUNTY ACCUM CAP OUTLAY	0.000120523	0.0120 %	0.010988070	0.000001324	0.000000000	0.000120523
003.01	L A COUNTY LIBRARY	0.030814847	3.0814 %	0.010988070	0.000338595	-0.0000338595	0.030476252
007.30	CONSOL. FIRE PRO.DIST.OF L.A.CO.	0.122582056	12.2582 %	0.010988070	0.001346940	-0.001346940	0.121235116
007.31	L A C FIRE,FEW	0.007926822	0.7926 %	0.010988070	0.000087100	0.000000000	0.007926822
030.10	L.A.CO.FL.CON.DR.IMP.DIST.MAINT.	0.002835658	0.2835 %	0.010988070	0.000031158	-0.000031158	0.002804500
030.70	LA CO FLOOD CONTROL MAINT	0.016050131	1.6050 %	0.010988070	0.000176359	-0.000176359	0.015873772
061.80	GREATER L A CO VECTOR CONTROL	0.000582146	0.0582 %	0.010988070	0.000006396	-0.000006396	0.000575750
066.30	CO SANITATION DIST NO 8 OPERAT	0.013702748	1.3702 %	0.010988070	0.000150566	-0.000150566	0.013552182
125.01	CARSON - RP #1/'97 ANNEX	0.070000000	7.0000 %	0.010988070	0.000769164	-0.000769164	0.069230836
350.90	WTR REPLENISHMENT DIST OF SO CAL	0.000137932	0.0197 %	0.010988070	0.000002174	-0.000002174	0.000195758
400.00	EDUCATIONAL REV AUGMENTATION FD	0.000000000	0.0000 %	0.010988070	0.000000000	EXEMPT	0.000000000
400.01	EDUCATIONAL AUG FD IMPOUND	0.000000000	0.0000 %	0.010988070	0.000000000	EXEMPT	0.000000000
400.15	COUNTY SCHOOL SERVICES	0.001494777	0.1494 %	0.010988070	0.000016424	EXEMPT	0.001494777
400.21	CHILDREN'S INSTIL TUITION FUND	0.002966607	0.2966 %	0.010988070	0.000032597	EXEMPT	0.002966607
805.04	L.A.CITY COMMUNITY COLLEGE DIST	0.031900083	3.1900 %	0.010988070	0.000350520	EXEMPT	0.031900083
805.20	L.A.COMM.CO.L.CHILDREN'S CTR FD	0.000329846	0.0329 %	0.010988070	0.000003624	EXEMPT	0.000329846
887.03	LOS ANGELES UNIFIED SCHOOL DIST	0.234862241	23.4862 %	0.010988070	0.002580682	EXEMPT	0.234862241
887.06	CO.SCH.SERV.FD.- LOS ANGELES	0.000013091	0.0013 %	0.010988070	0.000000143	EXEMPT	0.000013091

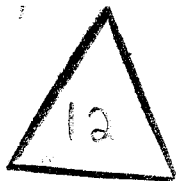

PROPERTY TAX TRANSFER RESOLUTION WORKSHEET
FISCAL YEAR 2012-2013

ANNEXATION NUMBER: TR 71748		PROJECT NAME: TRACT NO. 71748		TRA: 05475			
ACCOUNT #	TAKING AGENCY	CURRENT TAX SHARE	PERCENT	PROPOSED DIST SHARE	ALLOCATED SHARE	ADJUSTMENTS	NET SHARE
887.07	DEV. CTR. HDCPD MINOR-L A UNIF.	0.001324720	0.1324 %	0.010988070	0.000014556	EXEMPT	0.001324720
887.20	LOS ANGELES CHILDRENS CENTER FD	0.003853719	0.3853 %	0.010988070	0.000042344	EXEMPT	0.003853719
**019.56	CO LIGHTING MAINT DIST NO 1697	0.000000000	0.0000 %	0.010988070	0.000000000	0.000000000	0.007947180
TOTAL:		1.000000000	100.0000 %		0.010988070	-0.007947180	1.000000000

ANNEXATION TO: CO LIGHTING MAINT DIST NO 1697

ACCOUNT NUMBER: 019.56

TRA: 05479

EFFECTIVE DATE: 07/01/2013

ANNEXATION NUMBER: TR 71748

PROJECT NAME: TRACT NO. 71748

DISTRICT SHARE: 0.010988070

ACCOUNT #	TAXING AGENCY	CURRENT TAX SHARE	PERCENT	PROPOSED DIST SHARE	ALLOCATED SHARE	ADJUSTMENTS	NET SHARE
001.05	LOS ANGELES COUNTY GENERAL	0.458441905	45.8451 %	0.010988070	0.005037402	-0.005125826	0.453316079
001.20	L.A. COUNTY ACCUM CAP OUTLAY	0.000120520	0.0120 %	0.010988070	0.000001324	0.000000000	0.000120520
003.01	L A COUNTY LIBRARY	0.030814859	3.0814 %	0.010988070	0.000338595	-0.000338595	0.030476264
007.30	CONSOL. FIRE PRO.DIST.OF L.A.CO.	0.122582075	12.2582 %	0.010988070	0.001346940	-0.001346940	0.121235135
007.31	L A C FIRE-FFW	0.007926819	0.7926 %	0.010988070	0.0000087100	0.000000000	0.007926819
030.10	L.A.CO.FL.CON.DR.IMP.DIST.MAINT.	0.002835662	0.2835 %	0.010988070	0.000031158	-0.000031158	0.002804504
030.70	LA CO FLOOD CONTROL MAINT	0.016050146	1.6050 %	0.010988070	0.000176360	-0.000176360	0.015873786
061.80	GREATER L A CO VECTOR CONTROL	0.000582148	0.0582 %	0.010988070	0.000006396	-0.000006396	0.000575752
066.30	CO SANITATION DIST NO 8 OPERAT	0.013702747	1.3702 %	0.010988070	0.000150566	-0.000150566	0.013552181
125.01	CARSON - RP #1/'97 ANNEX	0.070000000	7.0000 %	0.010988070	0.000769164	-0.000769164	0.069230836
350.90	WTR REPLENISHMENT DIST OF SO CAL	0.000197940	0.0197 %	0.010988070	0.000002174	-0.000002174	0.000195766
400.00	EDUCATIONAL REV AUGMENTATION FD	0.000000000	0.0000 %	0.010988070	0.000000000	EXEMPT	0.000000000
400.01	EDUCATIONAL AUG FD IMPOUND	0.000000000	0.0000 %	0.010988070	0.000000000	EXEMPT	0.000000000
400.15	COUNTY SCHOOL SERVICES	0.001494777	0.1494 %	0.010988070	0.000016424	EXEMPT	0.001494777
400.21	CHILDREN'S INSTIL TUITION FUND	0.002966605	0.2966 %	0.010988070	0.000032597	EXEMPT	0.002966605
805.04	L.A.CITY COMMUNITY COLLEGE DIST	0.031900090	3.1900 %	0.010988070	0.0000350520	EXEMPT	0.031900090
805.20	L.A.COMM.COLL.CHILDREN'S CTR FD	0.000329848	0.0329 %	0.010988070	0.000003624	EXEMPT	0.000329848
887.03	LOS ANGELES UNIFIED SCHOOL DIST	0.234862320	23.4862 %	0.010988070	0.002580683	EXEMPT	0.234862320
887.06	CO.SCH.SERV.FD.- LOS ANGELES	0.000013096	0.0013 %	0.010988070	0.000000143	EXEMPT	0.000013096



PROPERTY TAX TRANSFER RESOLUTION WORKSHEET
FISCAL YEAR 2012-2013

LIUK ALAKANU3

ANNEXATION NUMBER: TR 71748		PROJECT NAME: TRACT NO. 71748		TRA: 05479			
ACCOUNT #	TAXING AGENCY	CURRENT TAX SHARE	PERCENT	PROPOSED DIST SHARE	ALLOCATED SHARE	ADJUSTMENTS	NET SHARE
887.07	DEV. CTR. HDCPD MINOR-L A UNIF.	0.001324721	0.1324 %	0.010988070	0.000014556	EXEMPT	0.001324721
887.20	LOS ANGELES CHILDRENS CENTER FD	0.003853722	0.3853 %	0.010988070	0.000042344	EXEMPT	0.003853722
***019.56	CO LIGHTING MAINT DIST NO 1697	0.000000000	0.0000 %	0.010988070	0.000000000	0.000000000	0.007947179
TOTAL:		1.000000000	100.0000 %		0.010988070	-0.007947179	1.000000000

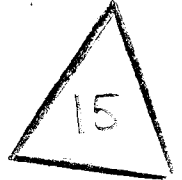

RESOLUTION NO. 13-107

A JOINT RESOLUTION OF THE BOARD OF SUPERVISORS OF THE COUNTY OF LOS ANGELES; THE BOARD OF TRUSTEES OF THE GREATER LOS ANGELES COUNTY VECTOR CONTROL DISTRICT; THE BOARD OF DIRECTORS OF THE COUNTY SANITATION DISTRICT NO. 8 OF LOS ANGELES COUNTY (COUNTY SANITATION DISTRICT NO. 8); THE CITY COUNCIL OF THE CITY OF CARSON, CALIFORNIA; AND THE BOARD OF DIRECTORS OF THE WATER REPLENISHMENT DISTRICT OF SOUTHERN CALIFORNIA APPROVING AND ACCEPTING THE NEGOTIATED EXCHANGE OF PROPERTY TAX REVENUES RESULTING FROM ANNEXATION OF L 049-2012 TO COUNTY LIGHTING MAINTENANCE DISTRICT 1697

WHEREAS, pursuant to Section 99.01 of the California Revenue and Taxation Code, prior to the effective date of any jurisdictional change that will result in a special district providing one or more services to an area where those services have not previously been provided by any local agency, the special district and each local agency that receives an apportionment of property tax revenue from the area must negotiate an exchange of property tax increment generated in the area subject to the jurisdictional change and attributable to those local agencies; and

WHEREAS, the Board of Supervisors of the county of Los Angeles, acting on behalf of the County Lighting Maintenance District 1697, the Los Angeles County General Fund, the Los Angeles County Library, the Consolidated Fire Protection District of Los Angeles County, the Los Angeles County Flood Control Drainage Improvement District, and the Los Angeles County Flood Control District; the Board of Trustees of the Greater Los Angeles County Vector Control District; the Board of Directors of the County Sanitation District No. 8 of Los Angeles County (County Sanitation District No. 8); the City Council of the City of Carson; and the Board of Directors of the Water Replenishment District of Southern California have determined that the amount of property tax revenue to be exchanged between their respective agencies as a result of the annexation proposal identified as L 049-2012 to County Lighting Maintenance District 1697 is as shown on the enclosed Property Tax Transfer Resolution Worksheet.

NOW, THEREFORE, be it determined by the City Council of the City of Carson, California, that:

Section 1. The negotiated exchange of property tax revenues between the County Lighting Maintenance District 1697, and the Los Angeles County General Fund, the Los Angeles County Public Library, the Consolidated Fire Protection District of Los Angeles County, the Los Angeles County Flood Control Drainage Improvement District, the Los Angeles County Flood Control District; the Greater Los Angeles County Vector Control District, the County Sanitation District No. 8, the City of Carson, and the Water Replenishment District of Southern California resulting from the annexation proposal identified as L 049-2012 to County Lighting Maintenance District 1697 is approved and accepted.

[MORE]

EXHIBIT NO. 03



Section 2. For annexation projects within a City of Carson Community Redevelopment Project Area (RPA), County Lighting Maintenance District 1697 will not receive the negotiated share of annual tax increment (ATI) until such time as the affected RPA is terminated for purposes of receiving an ATI.

Section 3. For fiscal years commencing on or after July 1, 2013, or the July 1 after the effective date of this jurisdictional change, whichever is later, the property tax revenue increment generated from the area within L 049-2012 (Tax Rate Area 01183) shall be allocated to the affected agencies as indicated in the enclosed Property Tax Transfer Resolution Worksheet.

Section 4. No transfer of property tax revenues other than those specified in Paragraph 3 shall be made as a result of annexation of L 049-2012.

Section 5. If at any time after the effective date of this resolution, the calculations used herein to determine initial property tax transfers or the data used to perform those calculations are found to be incorrect, thus producing an improper or inaccurate property tax transfer, the property tax transfer shall be recalculated and the corrected transfer shall be implemented for the next fiscal year, and any amounts of property tax received in excess of that which is proper shall be refunded to the appropriate agency.

PASSED, APPROVED, and ADOPTED this ____ day of _____, 2013.

Mayor Jim Dear

ATTEST:

City Clerk Donesia L. Gause, CMC

APPROVED AS TO FORM:

City Attorney

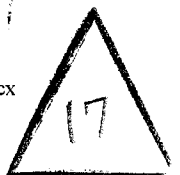

ANNEXATION TO: CO LIGHTING MAINT DIST NO 1697
 ACCOUNT NUMBER: 019.56
 TRA: 01183
 EFFECTIVE DATE: 07/01/2013
 ANNEXATION NUMBER: L 049-2012
 PROJECT NAME: L 049-2012
 DISTRICT SHARE: 0.010988070

ACCOUNT #	TAXING AGENCY	CURRENT TAX SHARE	PERCENT	PROPOSED DIST SHARE	ALLOCATED SHARE	ADJUSTMENTS	NET SHARE
001.05	LOS ANGELES COUNTY GENERAL	0.430058994	43.0068 %	0.010988070	0.004725527	-0.004806069	0.425252925
001.20	L.A. COUNTY ACCUM CAP OUTLAY	0.0000113407	0.0113 %	0.010988070	0.000001246	0.000000000	0.000113407
003.01	L A COUNTY LIBRARY	0.028995689	2.8995 %	0.010988070	0.000318606	-0.000318606	0.028677083
007.30	CONSOL. FIRE PRO.DIST.OF L.A.CO.	0.174380537	17.4380 %	0.010988070	0.001916105	-0.001916105	0.172464432
007.31	L A C FIRE-FFW	0.007216626	0.7216 %	0.010988070	0.000079296	0.000000000	0.007216626
030.10	L.A.CO.FL.CON.DR.IMP.DIST.MAINT.	0.002668257	0.2668 %	0.010988070	0.000029318	-0.000029318	0.002638939
030.70	LA CO FLOOD CONTROL MAINT	0.015102606	1.5102 %	0.010988070	0.000165948	-0.000165948	0.014936658
061.80	GREATER L A CO VECTOR CONTROL	0.000547781	0.0547 %	0.010988070	0.000006019	-0.000006019	0.000541762
066.30	CO SANITATION DIST NO 8 OPERAT	0.012893800	1.2893 %	0.010988070	0.000141677	-0.000141677	0.012752123
125.01	CARSON - RP# 1 - 85 ANX	0.067428693	6.7428 %	0.010988070	0.000740911	-0.000740911	0.066687782
350.90	WTR REPLENISHMENT DIST OF SO CAL	0.000186248	0.0186 %	0.010988070	0.000002046	-0.000002046	0.000184202
400.00	EDUCATIONAL REV AUGMENTATION FD	0.000000000	0.0000 %	0.010988070	0.000000000	EXEMPT	0.000000000
400.01	EDUCATIONAL AUG FD IMPOUND	0.000000000	0.0000 %	0.010988070	0.000000000	EXEMPT	0.000000000
400.15	COUNTY SCHOOL SERVICES	0.001406532	0.1406 %	0.010988070	0.000015455	EXEMPT	0.001406532
400.21	CHILDREN'S INSTIL TUITION FUND	0.002791474	0.2791 %	0.010988070	0.000030672	EXEMPT	0.002791474
805.04	L.A.CITY COMMUNITY COLLEGE DIST	0.030016857	3.0016 %	0.010988070	0.000329827	EXEMPT	0.030016857
805.20	L.A.COMM.COLL.CHILDREN'S CTR FD	0.000310376	0.0310 %	0.010988070	0.000003410	EXEMPT	0.000310376
887.03	LOS ANGELES UNIFIED SCHOOL DIST	0.220997075	22.0997 %	0.010988070	0.002428331	EXEMPT	0.220997075
887.06	CO.SCH.SERV.FD.- LOS ANGELES	0.000012321	0.0012 %	0.010988070	0.000000135	EXEMPT	0.000012321

ANNEXATION NUMBER: L 049-2012 PROJECT NAME: L 049-2012

TRA: 01183

ACCOUNT #	TAXING AGENCY	CURRENT TAX SHARE	PERCENT	PROPOSED DIST SHARE	ALLOCATED SHARE	ADJUSTMENTS	NET SHARE
887.07	DEV. CTR. HDCPD MINOR-L A UNIF.	0.001246512	0.1246 %	0.010988070	0.000013696	EXEMPT	0.001246512
887.20	LOS ANGELES CHILDRENS CENTER FD	0.003626215	0.3626 %	0.010988070	0.000039845	EXEMPT	0.003626215
***019.56	CO LIGHTING MAINT DIST NO 1697	0.000000000	0.0000 %	0.010988070	0.000000000	0.000000000	0.008126699
TOTAL:					1.000000000	100.0000 %	0.010988070
						-0.008126699	1.000000000

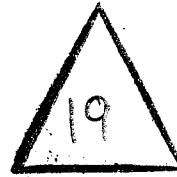

TRACT NO. 71748

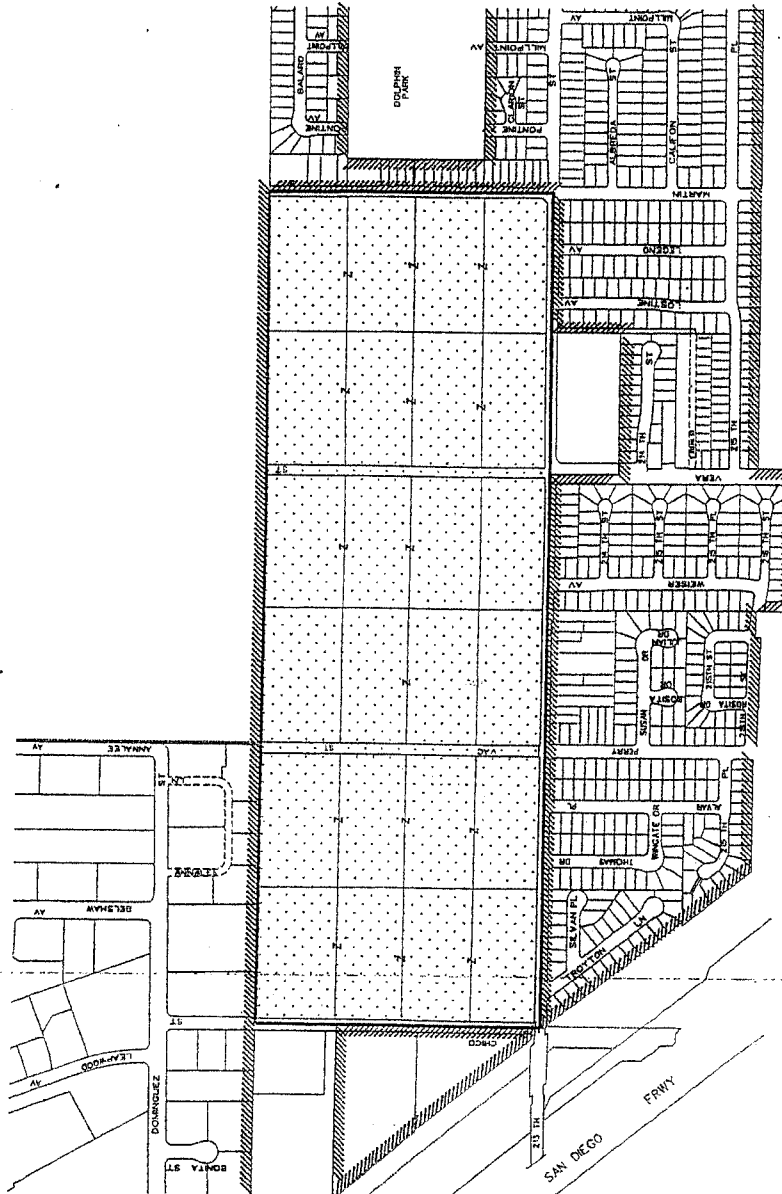

LEGEND

PROPOSED ANNEXATION AREA

EXISTING LIGHTING MAINTENANCE DISTRICT 1697

PROPOSED ANNEXATION TO COUNTY
LIGHTING MAINTENANCE DISTRICT 1697
AND COUNTY LIGHTING DISTRICT LLA-1
(CARSON ZONE)

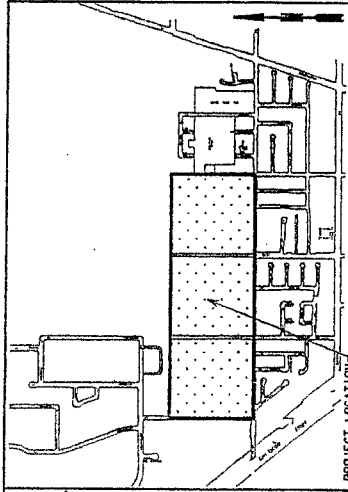

PROJECT LOCATION
VICINITY MAP

T. G. page 764-F&G.5

TRA	APN
5475	7326 001 003
5479	7326 001 004
	7327 002 008
	7327 003 002
	7327 003 003
	7327 003 004
	7327 003 005
	7327 003 006
	7327 003 007
	7327 003 009
	7327 003 021

NOT TO SCALE

LDS ANGELES COUNTY DEPARTMENT OF PUBLIC WORKS
TRAFFIC AND LIGHTING DIVISION
STREET LIGHTING SECTION

CLMD 1697
CITY OF CARSON

Prepared By	ID	Sheet 1 of 1	SUP. DIST. 2
Recommended By	<i>David Phillips</i>	Date	2/5/13
Approved By	<i>George Han</i>	Date	2/6/13

TR 71748

L 049-2012

EXHIBIT NO. 05

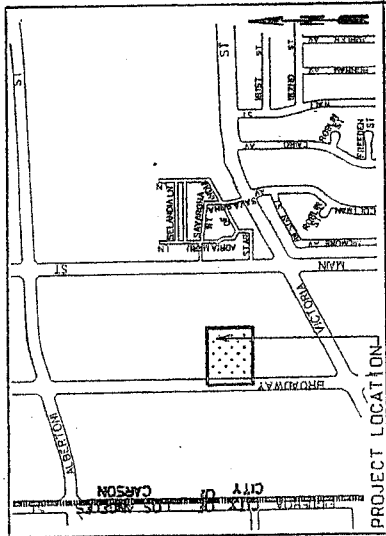

T. G. page 764-C1

TRA
1183
APN
7339 004 001
7339 004 002
7339 004 003

NOT TO SCALE

LEGEND

PROPOSED ANNEXATION AREA

EXISTING LIGHTING MAINTENANCE DISTRICT 1697

PROPOSED ANNEXATION TO COUNTY
LIGHTING MAINTENANCE DISTRICT 1697
AND COUNTY LIGHTING DISTRICT LLA-1
(CARSON ZONE)

LOS ANGELES COUNTY DEPARTMENT OF PUBLIC WORKS
TRAFFIC AND LIGHTING DIVISION
STREET LIGHTING SECTION

CLMD 1697

CITY OF CARSON

Prepared By TD Sheet 1 of 1 SUP. DIST. 2

Recommended By *Yashika P. [Signature]* Date 7/1/13

Approved By *[Signature]* Date 7/1/13

ANNEXATION TO: CO LIGHTING MAINT DIST NO 1697
ACCOUNT NUMBER: 019.56
TRA: 05475
EFFECTIVE DATE: 07/01/2013
ANNEXATION NUMBER: TR 71748 PROJECT NAME: TRACT NO. 71748
DISTRICT SHARE: 0.010988070

ACCOUNT #	TAXING AGENCY	CURRENT TAX SHARE	PERCENT	PROPOSED DIST SHARE	ALLOCATED SHARE	ADJUSTMENTS	NET SHARE
001.05	LOS ANGELES COUNTY GENERAL	0.458442053	45.8451 %	0.010988070	0.005037404	-0.005125828	0.453316225
001.20	L.A. COUNTY ACCUM CAP OUTLAY	0.000120523	0.0120 %	0.010988070	0.000001324	0.000000000	0.000120523
003.01	L A COUNTY LIBRARY	0.030814847	3.0814 %	0.010988070	0.000338595	-0.000338595	0.030476252
007.30	CONSOL. FIRE PRO.DIST.OF L.A.CO.	0.122582056	12.2582 %	0.010988070	0.001346940	-0.001346940	0.121235116
007.31	L A C FIRE-FFW	0.007926822	0.7926 %	0.010988070	0.000087100	0.000000000	0.007926822
030.10	L.A.CO.FL.CON.DR.IMP.DIST.MAINT.	0.002835658	0.2835 %	0.010988070	0.000031158	-0.000031158	0.002804500
030.70	LA CO FLOOD CONTROL MAINT	0.016050131	1.6050 %	0.010988070	0.000176359	-0.000176359	0.015873772
061.80	GREATER L A CO VECTOR CONTROL	0.000582146	0.0582 %	0.010988070	0.000006396	-0.000006396	0.000575750
066.30	CO SANITATION DIST NO 8 OPERAT	0.013702748	1.3702 %	0.010988070	0.000150566	-0.000150566	0.013552182
125.01	CARSON - RP #1/'97 ANNEX	0.070000000	7.0000 %	0.010988070	0.000769164	-0.000769164	0.069230836
350.90	WTR REPLENISHMENT DIST OF SO CAL	0.000197932	0.0197 %	0.010988070	0.000002174	-0.000002174	0.000195758
400.00	EDUCATIONAL REV AUGMENTATION FD	0.000000000	0.0000 %	0.010988070	0.000000000	EXEMPT	0.000000000
400.01	EDUCATIONAL AUG FD IMPOUND	0.000000000	0.0000 %	0.010988070	0.000000000	EXEMPT	0.000000000
400.15	COUNTY SCHOOL SERVICES	0.001494777	0.1494 %	0.010988070	0.000016424	EXEMPT	0.001494777
400.21	CHILDREN'S INSTIL TUITION FUND	0.002966607	0.2966 %	0.010988070	0.000032597	EXEMPT	0.002966607
805.04	L.A.CITY COMMUNITY COLLEGE DIST	0.031900083	3.1900 %	0.010988070	0.000350520	EXEMPT	0.031900083
805.20	L.A.COMM.COLL.CHILDREN'S CTR FD	0.000329846	0.0329 %	0.010988070	0.000003624	EXEMPT	0.000329846
887.03	LOS ANGELES UNIFIED SCHOOL DIST	0.234862241	23.4862 %	0.010988070	0.002580682	EXEMPT	0.234862241
887.06	CO.SCH.SERV.FD.- LOS ANGELES	0.000013091	0.0013 %	0.010988070	0.000000143	EXEMPT	0.000013091

EXHIBIT NO. 06

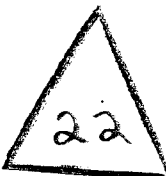

ANNEXATION NUMBER: TR 71748		PROJECT NAME: TRACT NO. 71748		TRA: 05475			
ACCOUNT #	TAXING AGENCY	CURRENT TAX SHARE	PERCENT	PROPOSED DIST SHARE	ALLOCATED SHARE	ADJUSTMENTS	NET SHARE
887.07	DEV. CTR. HDCPD MINOR-L A UNIF.	0.001324720	0.1324 %	0.010988070	0.000014556	EXEMPT	0.001324720
887.20	LOS ANGELES CHILDRENS CENTER FD	0.003853719	0.3853 %	0.010988070	0.000042344	EXEMPT	0.003853719
***019.56	CO LIGHTING MAINT DIST NO 1697	0.000000000	0.0000 %	0.010988070	0.000000000	0.000000000	0.007947180
TOTAL:		1.000000000	100.0000 %		0.010988070	-0.007947180	1.000000000



ANNEXATION TO: CO LIGHTING MAINT DIST NO 1697

ACCOUNT NUMBER: 019.56

TRA: 05479

EFFECTIVE DATE: 07/01/2013

ANNEXATION NUMBER: TR 71748

PROJECT NAME: TRACT NO. 71748

DISTRICT SHARE: 0.010988070

ACCOUNT #	TAXING AGENCY	CURRENT TAX SHARE	PERCENT	PROPOSED DIST SHARE	ALLOCATED SHARE	ADJUSTMENTS	NET SHARE
001.05	LOS ANGELES COUNTY GENERAL	0.458441905	45.8451 %	0.010988070	0.005037402	-0.005125826	0.453316079
001.20	L.A. COUNTY ACCUM CAP OUTLAY	0.000120520	0.0120 %	0.010988070	0.000001324	0.000000000	0.000120520
003.01	L A COUNTY LIBRARY	0.030814859	3.0814 %	0.010988070	0.000338595	-0.000338595	0.030476264
007.30	CONSOL. FIRE PRO.DIST.OF L.A.CO.	0.123582075	12.2582 %	0.010988070	0.001346940	-0.001346940	0.121235135
007.31	L A C FIRE-FFW	0.007926819	0.7926 %	0.010988070	0.000087100	0.000000000	0.007926819
030.10	L.A.CO.FL.CON.DR.IMP.DIST.MAINT.	0.002835662	0.2835 %	0.010988070	0.000031158	-0.000031158	0.002804504
030.70	LA CO FLOOD CONTROL MAINT	0.016050146	1.6050 %	0.010988070	0.000176360	-0.000176360	0.015873786
061.80	GREATER L A CO VECTOR CONTROL	0.000582148	0.0582 %	0.010988070	0.000006396	-0.000006396	0.000575752
066.30	CO SANITATION DIST NO 8 OPERAT	0.013702747	1.3702 %	0.010988070	0.000150566	-0.000150566	0.013552181
125.01	CARSON - RP #1/'97 ANNEX	0.070000000	7.0000 %	0.010988070	0.000769164	-0.000769164	0.069230836
350.90	WTR REPLENISHMENT DIST OF SO CAL	0.000197940	0.0197 %	0.010988070	0.000002174	-0.000002174	0.000195766
400.00	EDUCATIONAL REV AUGMENTATION FD	0.000000000	0.0000 %	0.010988070	0.000000000	EXEMPT	0.000000000
400.01	EDUCATIONAL AUG FD IMPOUND	0.000000000	0.0000 %	0.010988070	0.000000000	EXEMPT	0.000000000
400.15	COUNTY SCHOOL SERVICES	0.001494777	0.1494 %	0.010988070	0.0000016424	EXEMPT	0.001494777
400.21	CHILDREN'S INSTIL TUITION FUND	0.002966605	0.2966 %	0.010988070	0.000032597	EXEMPT	0.002966605
805.04	L.A.CITY COMMUNITY COLLEGE DIST	0.031900090	3.1900 %	0.010988070	0.000350520	EXEMPT	0.031900090
805.20	L.A.COMM.COLL.CHILDREN'S CTR FD	0.000329848	0.0329 %	0.010988070	0.000003624	EXEMPT	0.000329848
887.03	LOS ANGELES UNIFIED SCHOOL DIST	0.234862320	23.4862 %	0.010988070	0.002580683	EXEMPT	0.234862320
887.06	CO.SCH.SERV.FD.- LOS ANGELES	0.000013096	0.0013 %	0.010988070	0.000000143	EXEMPT	0.000013096

ANNEXATION NUMBER: TR 71748		PROJECT NAME: TRACT NO. 71748		TRA: 05479			
ACCOUNT #	TAXING AGENCY	CURRENT TAX SHARE	PERCENT	PROPOSED DIST SHARE	ALLOCATED SHARE	ADJUSTMENTS	NET SHARE
887.07	DEV. CTR. HDCPD MINOR-L A UNIF.	0.001324721	0.1324 %	0.010988070	0.000014556	EXEMPT	0.001324721
887.20	LOS ANGELES CHILDRENS CENTER FD	0.003853722	0.3853 %	0.010988070	0.000042344	EXEMPT	0.003853722
***019.56	CO LIGHTING MAINT DIST NO 1697	0.000000000	0.0000 %	0.010988070	0.000000000	0.000000000	0.007947179
TOTAL:		1.000000000	100.0000 %		0.010988070	-0.007947179	1.000000000



ANNEXATION TO: CO LIGHTING MAINT DIST NO 1697
 ACCOUNT NUMBER: 019.56
 TRA: 01183
 EFFECTIVE DATE: 07/01/2013
 ANNEXATION NUMBER: L 049-2012 PROJECT NAME: L 049-2012
 DISTRICT SHARE: 0.010988070

ACCOUNT #	TAXING AGENCY	CURRENT TAX SHARE	PERCENT	PROPOSED DIST SHARE	ALLOCATED SHARE	ADJUSTMENTS	NET SHARE
001.05	LOS ANGELES COUNTY GENERAL	0.430058994	43.0068 %	0.010988070	0.004725527	-0.004806069	0.425252925
001.20	L.A. COUNTY ACCUM CAP OUTLAY	0.000113407	0.0113 %	0.010988070	0.000001246	0.000000000	0.000113407
003.01	L A COUNTY LIBRARY	0.028995689	2.8995 %	0.010988070	0.000318606	-0.000318606	0.028677083
007.30	CONSOL. FIRE PRO.DIST.OF L.A.CO.	0.174380537	17.4380 %	0.010988070	0.001916105	-0.001916105	0.172464432
007.31	L A C FIRE-FFW	0.007216626	0.7216 %	0.010988070	0.000079296	0.000000000	0.007216626
030.10	L.A.CO.FL. CON.DR.IMP.DIST.MAINT.	0.002668257	0.2668 %	0.010988070	0.000029318	-0.000029318	0.002638939
030.70	LA CO FLOOD CONTROL MAINT	0.015102606	1.5102 %	0.010988070	0.000165948	-0.000165948	0.014936658
061.80	GREATER L A CO VECTOR CONTROL	0.000547781	0.0547 %	0.010988070	0.000006019	-0.000006019	0.000541762
066.30	CO SANITATION DIST NO 8 OPERAT	0.012893800	1.2893 %	0.010988070	0.000141677	-0.000141677	0.012752123
125.01	CARSON - RP# 1 - 85 ANX	0.067428693	6.7428 %	0.010988070	0.000740911	-0.000740911	0.066687782
350.90	WTR REPLENISHMENT DIST OF SO CAL	0.000186248	0.0186 %	0.010988070	0.000002046	-0.000002046	0.000184202
400.00	EDUCATIONAL REV AUGMENTATION FD	0.000000000	0.0000 %	0.010988070	0.000000000	EXEMPT	0.000000000
400.01	EDUCATIONAL AUG FD IMPOUND	0.000000000	0.0000 %	0.010988070	0.000000000	EXEMPT	0.000000000
400.15	COUNTY SCHOOL SERVICES	0.001406532	0.1406 %	0.010988070	0.000015455	EXEMPT	0.001406532
400.21	CHILDREN'S INSTIL TUITION FUND	0.002791474	0.2791 %	0.010988070	0.0000030672	EXEMPT	0.002791474
805.04	L.A.CITY COMMUNITY COLLEGE DIST	0.030016857	3.0016 %	0.010988070	0.000329827	EXEMPT	0.030016857
805.20	L.A.COMM.COLL.CHILDREN'S CTR FD	0.000310376	0.0310 %	0.010988070	0.0000003410	EXEMPT	0.000310376
887.03	LOS ANGELES UNIFIED SCHOOL DIST	0.220997075	22.0997 %	0.010988070	0.002428331	EXEMPT	0.220997075
887.06	CO.SCH.SERV.FD.- LOS ANGELES	0.000012321	0.0012 %	0.010988070	0.000000135	EXEMPT	0.000012321

ANNEXATION NUMBER: L 049-2012 PROJECT NAME: L 049-2012 TRA: 01183

ACCOUNT #	TAXING AGENCY	CURRENT TAX SHARE	PERCENT	PROPOSED DIST SHARE	ALLOCATED SHARE	ADJUSTMENTS	NET SHARE
887.07	DEV. CTR. HDCPD MINOR-L A UNIF.	0.001246512	0.1246 %	0.010988070	0.000013696	EXEMPT	0.001246512
887.20	LOS ANGELES CHILDRENS CENTER FD	0.003626215	0.3626 %	0.010988070	0.000039845	EXEMPT	0.003626215
***019.56	CO LIGHTING MAINT DIST NO 1697	0.000000000	0.0000 %	0.010988070	0.000000000	0.000000000	0.008126699
TOTAL:		1.000000000	100.0000 %		0.010988070	-0.008126699	1.000000000



GAIL FARBER, Director

COUNTY OF LOS ANGELES

DEPARTMENT OF PUBLIC WORKS

"To Enrich Lives Through Effective and Caring Service"

900 SOUTH FREMONT AVENUE
ALHAMBRA, CALIFORNIA 91803-1331
Telephone: (626) 458-5100
<http://dpw.lacounty.gov>

ADDRESS ALL CORRESPONDENCE TO:
P.O. BOX 1460
ALHAMBRA, CALIFORNIA 91802-1460

October 17, 2013

IN REPLY PLEASE

REFER TO FILE: T-5

Mr. Gilbert Marquez
Acting Director of Public Works/City Engineer
City of Carson
701 East Carson Street
Carson, CA 90745-6234

Dear Mr. Marquez:

**STREET LIGHTING DISTRICTS
CONSENT AND JURISDICTION/NEGOTIATED TAX EXCHANGE RESOLUTIONS
RESULTING FROM ANNEXATION OF TERRITORIES TRACT NO. 71748 AND
L 049-2012 TO COUNTY LIGHTING MAINTENANCE DISTRICT 1697 AND
COUNTY LIGHTING DISTRICT LANDSCAPING AND LIGHTING ACT-1,
CARSON ZONE - CITY OF CARSON**

This letter supersedes the letter sent to you on August 15, 2013. The areas shown on the enclosed maps are being processed for annexation to County Lighting Maintenance District 1697 and County Lighting District Landscaping and Lighting Act-1, Carson Zone, in order to provide funds for the operation and maintenance of street lights installed by the developer. County Lighting Maintenance District 1697 is located wholly within the jurisdictional boundary of the City of Carson and is administered by the County of Los Angeles on behalf of the City. Since these are located within the City's jurisdiction, City Council approval of the enclosed Resolution Granting Consent and Jurisdiction to the County is required to accomplish this annexation.

In addition, enclosed are three Joint Resolutions between the County and the City approving and accepting the negotiated exchange of property tax revenues resulting from the annexation of the subject territories to County Lighting Maintenance District 1697. For new annexations to a County Lighting Maintenance District, our procedures require us to process the exchange of property tax revenues concurrent with the Board of Supervisors' approval of the annexation. Attached to the Joint Resolutions are Property Tax Transfer Resolution Worksheets prepared for each Tax Rate Area located within the annexation territories listing the share of the annual tax increment to be exchanged between the City, other nonexempt taxing agencies (school-related agencies are exempted by State law), and County Lighting Maintenance

EXHIBIT NO. 07

28

Mr. Gilbert Marquez
October 17, 2013
Page 2

District 1697. The tax-sharing ratios listed on the worksheets were calculated using a formula approved by the Auditor-Controller and County Counsel. Upon the City's approval of the resolutions, we will continue the annexation processing for this project and schedule a public hearing before the Board.

The costs for the operation and maintenance of street lights located within a County Lighting Maintenance District are primarily funded by ad valorem property tax. The collection of property tax revenues has allowed County Lighting Maintenance District 1697 to maintain a low \$35 annual base assessment rate for a single-family home within the Carson Zone. As shown on the Property Tax Transfer Resolution Worksheet for Tract No. 71748, Tax Rate Area 05475, the current tax share ratio for the City is 0.070000000. Out of the City's tax share ratio, the City would allocate 0.000769164 to County Lighting Maintenance District 1697, with a net share to the City of 0.069230836, or monetarily speaking, a \$10,000 increment in assessed valuation of a parcel means that the parcel will pay an additional \$100 in property taxes, of which the City would receive \$6.9231 and County Lighting Maintenance District 1697 would receive \$0.0769. For areas in a Community Redevelopment Zone, County Lighting Maintenance District 1697 will not receive any tax dollars until such time that the Community Redevelopment Zone is terminated.

We prepared the resolutions for your use in this matter. Please have the resolutions executed and returned to us in the enclosed self-addressed envelope by November 13, 2013.

If you have any questions, please contact Ms. Tigist Desta of Traffic and Lighting Division, Street Lighting Section, at (626) 300-4755.

Very truly yours,

GAIL FARBER
Director of Public Works

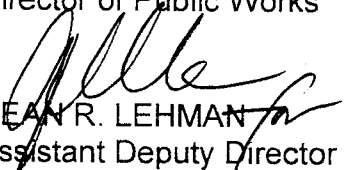
DEAN R. LEHMAN
Assistant Deputy Director
Traffic and Lighting Division

TD:dj

p:\t\pub\wpfiles\files\stl\td\city(c&j's)\cj carson\cj TR71748&L049-2012(2).doc

Enc.

